



Thanks for giving your Starmate 7 a good home. You're probably anxious to get started.

Before you decide to install this kit yourself, we'd like to suggest getting a pro to help. We want you to be 100% satisfied with your satellite radio experience. Just visit your local retailer for installation, or visit [www.siriusxm.ca](http://www.siriusxm.ca) to learn more.

Here's a simple guide for those who prefer doing this kind of stuff themselves. For more detailed information, visit [www.siriusxm.ca](http://www.siriusxm.ca) to view the User Guide.

## 1 Find a Location for Your Radio and Mount It

**A. Attach the mount to vehicle dock.**  
Using the screws provided, attach the vehicle dock to the vent mount.

**B. Attach to vent.**  
If the vent louvers in your vehicle are recessed, you may need to use the longer vent hooks with the vent mount. Be sure to match the orientation of the vent hooks as shown. Position the two tension springs against a heating / AC vent louver. Then gently push the vent mount into the vent, far enough so that the hooks drop down and hook the rear of the vent louver. Once the hooks have grasped a vent louver, the tension springs will keep the vent mount hooked to the louver. Use support foot to brace the radio in place.

Refer to page 14 in the User Guide if you prefer more detailed instructions.

**Radio mount placement options for windshield.**

Windshield mounting is an alternate method. Refer to the User Guide for details.

**AIR VENT**

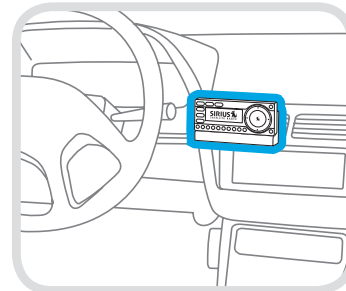
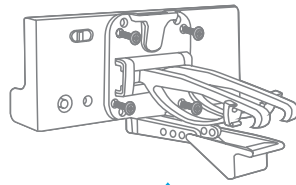

To change the angle of the vehicle dock, move the foot to a different adjustment hole on the vent mount.

**WINDSHIELD**

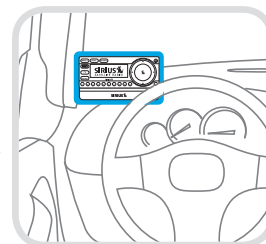
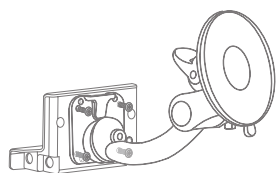

**BE SAFE:**  
Make sure your radio isn't in a place where it could interfere with driver visibility or safe deployment of the airbags.



**BE SMART:**  
Additional vehicle installation accessories are available at your satellite radio retailer or visit [siriusxm.ca](http://siriusxm.ca) for more information.

## 2 Mount the Magnetic Mount Antenna

Here are some general guidelines. For more tips and details, check out your User Guide or go to [siriusxm.ca](http://siriusxm.ca).

**A. Placing the antenna outside.**  
Leave at least 3" of metal around the antenna. Use the rubber tail cover to hide and protect the exposed wire. Feed the wire under the rubber molding around the back windshield, into the seal around the trunk wall and into the interior cabin from there.

**B. Hiding the antenna wire inside.**

The best place to hide your antenna wire depends on your vehicle. It's usually easiest to run the wire from the rear of the vehicle to the front toward the radio by routing the cable along the interior trim where it meets the carpet, by gently pushing it behind the edges of the trim. Then bring the cable out from trim and route under carpet to dashboard or console. Plug cable into the radio and coil extra wire under carpet or floor mat.

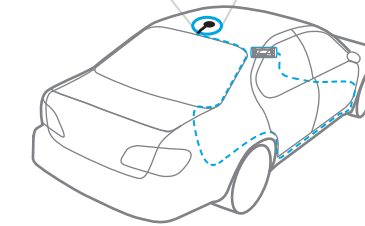
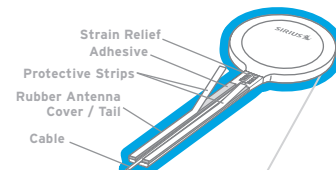

**SEDAN**

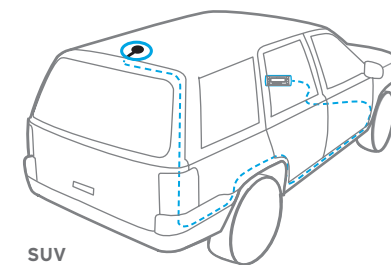

**SUV**



**BE CAREFUL:**  
STOP and read the more detailed instructions – or get a pro to help. If you don't understand what to do next, you might accidentally do damage to your ride.



**BE SAFE:**  
Not properly placing or installing the antenna can create safety hazards during an accident.



**BE SMART:**  
A dry car is nice. Avoid damaging or compromising the window and trunk seals.



**BE SMART:**  
Use a tool like a blunt plastic putty knife to help hide wires along the trim.

**Antenna placement options for other vehicles.**

**PICKUP TRUCK**  
Above front windshield, on the roof toward front of cab. Centered between right and left sides.

**CONVERTIBLE**  
On trunk lid, at least 3" from seam. Centered between right and left sides.

## 3 Connect the Audio



**BE SMART:**  
Other options, – like a direct FM connection or rear Auxiliary Input – may give you better audio quality, but may require pro installation.

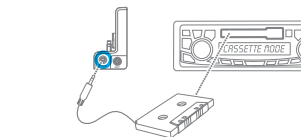
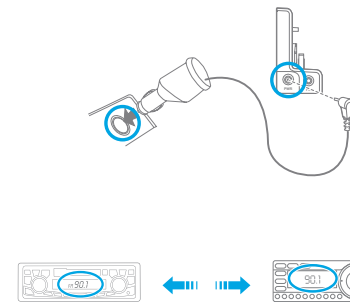

Audio Quality	GOOD	BETTER	BEST
A. PowerConnect	★		
B. Cassette Adaptor	★		
C. Auxiliary Input	★		

**First, power up.**

Plug in the PowerConnect Power Adapter. This goes into your cigarette lighter. Now, choose either A,B, or C below.

**OPTION A** Connect

Select an FM station on your radio that is not in use – you should only hear static. (Visit [siriusxm.ca](http://siriusxm.ca) to find available stations in your area.) Turn on Starmate 7 and press and hold the FM Preset button  for 2 seconds to access the FM Presets list. Then choose FM Preset 1-5 to program and match the same FM station as your car radio.

**OPTION B** Cassette Adaptor

Sold separately.

**OPTION C** Input Jack (Aux / Line In)

Found in some newer vehicles.

## 4 Subscribe

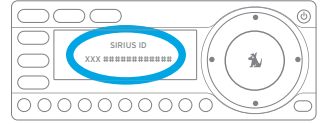

Test your radio and get its ID.

Please turn to channel #184 to make sure your radio is getting signal and sound. Now find the 12 digit Sirius ID number on the bottom of the box or by selecting:

**Power > Menu > SIRIUS ID (or) channel #0**

Activate your radio.

Subscribe online: [www.siriusxm.ca/activate](http://www.siriusxm.ca/activate)  
(or) subscribe by phone: 1.888.539.7474

## What's in the Box?

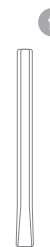
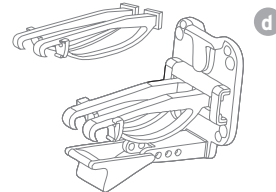
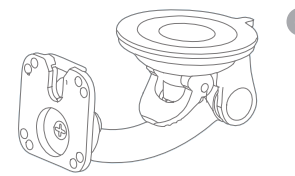
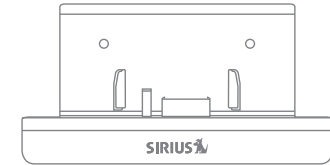
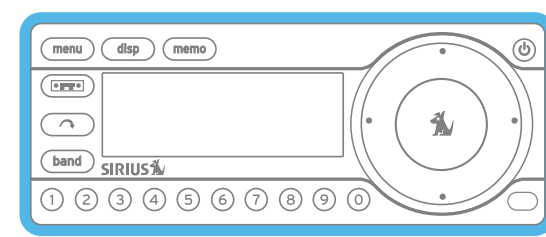

- a. radio
- b. PowerConnect vehicle dock
- c. dash mount
- d. vent mount
- e. antenna
- f. antenna cover/tail
- g. PowerConnect power adaptor
- h. screws
- i. alcohol pads
- j. aux in cable

Self installation instructions and tips are provided for your convenience. It is your responsibility to determine if you have the knowledge, skills and physical ability required to properly perform an installation. SiriusXM shall have no liability for damage or injury resulting from the installation or use of any SiriusXM or third party products. It is your responsibility to ensure that all products are installed in adherence with local laws and regulations and in such a manner as to allow a vehicle to be operated safely and without distraction. SiriusXM warranties do not cover the installation, removal or reinstallation of any product.

[www.siriusxm.ca](http://www.siriusxm.ca)

Sirius XM Canada Inc.  
135 Liberty St. - 4th Floor  
Toronto, Ontario, M6K 1A7

© 2013 SIRIUS XM Radio Inc. "SiriusXM", the SiriusXM logo, channel names and logos are trademarks of Sirius XM Radio Inc. and are used under license.

Getting Started ST7 (00000000000000)  
00.ABCD1.001 (120711b)



## Quick Start Guide

**Starmate 7**  
**Radio & Vehicle Kit**