



## **User Guide**

**Sportster 6**

Satellite Radio



## **Congratulations on the Purchase of your new SIRIUS Sportster 6 Radio**

Your new SIRIUS Sportster™ 6 Radio lets you enjoy 120 channels including commercial-free music, plus sports, talk and comedy. You can move effortlessly between your car, home, office, or on-the-go with a compatible accessory (sold separately).

Use this manual to familiarize yourself with all of the Sportster 6 features and capabilities. For the latest information about the Sportster 6 and other SIRIUS radios and accessories, visit [sirius.ca](http://sirius.ca).



# Table of Contents

<b>TABLE OF CONTENTS</b>	<b>4</b>
<b>WARNING AND SAFETY INFORMATION</b>	<b>6</b>
Industry Canada (IC) Statement	6
Canadian Compliance	7
General Precautions	7
Warnings	8
<b>COPYRIGHTS &amp; TRADEMARKS</b>	<b>10</b>
<b>PACKAGE CONTENTS</b>	<b>11</b>
<b>VEHICLE INSTALLATION</b>	<b>14</b>
Installing the Magnetic Antenna	21
Antenna Mounting	22
Cable Routing	24
Tips	32
Connecting the <i>PowerConnect</i> Power Adapter	37
Connecting Your SIRIUS Radio to Your Vehicle's Audio System	38
<b>CONTROLS</b>	<b>48</b>
Sportster 6 Front Panel	48
Remote Control Buttons	51
<i>PowerConnect</i> Vehicle Dock Reference Guide	54
<b>OPERATION</b>	<b>55</b>
Display Screen Information	55
Navigating Menus and Lists	56
Display (Disp) Button	56
Search Modes (Preset, Category, Channel, Artist, Song Title)	58
Direct Tuning	61
Channel Presets	61
Jump Button	63

Memory (MEMO) and Song Seek (S-Seek) Functions . . . . .	64
Sports Alert . . . . .	72
Instant Replay . . . . .	73
FM Presets Button . . . . .	77
<b>MENU OPTIONS . . . . .</b>	<b>78</b>
Sirius ID . . . . .	79
Settings . . . . .	80
FM Transmitter . . . . .	81
Display Settings . . . . .	82
S-Seek alert settings . . . . .	86
Audio Level . . . . .	87
Channel Preview . . . . .	88
Factory Default . . . . .	89
Parental Control . . . . .	90
Sports Alerts . . . . .	92
Sports Selections . . . . .	93
NASCAR . . . . .	93
NFL, NBA, College football, college basketball . . . . .	95
Clock . . . . .	97
Alarm . . . . .	98
Program Alert . . . . .	99
Auto Shutdown . . . . .	100
Sleep Mode . . . . .	100
Signal Indicator . . . . .	101
<b>SPECIFICATIONS. . . . .</b>	<b>103</b>
<b>SIRIUS ID . . . . .</b>	<b>105</b>

# Warning and Safety Information

## Industry Canada (IC) Statement

Operation is subject to the following two conditions: (1) this device may not cause interference, and (2) this device must accept any interference, including interference that may cause undesired operation of the device.

To reduce potential radio interference to other users, the antenna type and its gain should be so chosen that the equivalent isotropically radiated power (e.i.r.p.) is not more than that permitted for successful communication.

This device has been designed to operate with the antennas listed below, and having a maximum gain of 7.0 dB. The typical 5.5 dB antennas not included in this list or having a gain greater than 7 dB are strictly prohibited for use with this device. The required antenna impedance is 50 ohms.

Note: This equipment has been tested and found to comply with the limits for a CLASS B digital device, pursuant to Part 15 of the FCC Rules. These limits are designed to provide reasonable protection against harmful interference when the equipment is operated in a commercial environment. This equipment generates, uses, and can radiate radio frequency energy and, if not installed and used in accordance with the instructions, may cause harmful interference to radio communications. However, there is no guarantee that interference will not occur in a particular installation. If this equipment does cause harmful interference to radio or television reception, which can be determined by turning the equipment off and on, the user is encouraged to try to correct the interference by one or more of the following measures:

1. Reorient or relocate the receiving antenna.
2. Increase the separation between the equipment and the receiver.
3. Connect the equipment into an outlet on a circuit different from that to which the receiver is connected.
4. Consult the dealer or an experienced radio/TV technician for help.

## **WARNING**

Changes or modifications not expressly approved by the manufacturer could void the user's authority to operate the equipment.

## Canadian Compliance

This Class B digital apparatus complies with Canadian ICES-003.

## General Precautions

### **Liquid Crystal Precautions**

If the LCD screen on the Sportster 6 is damaged, do not touch the liquid crystal fluid. If any of the following situations happen, take the action indicated:

1. If the liquid crystal fluid comes in contact with your skin, wipe the skin area with a cloth and then wash the skin thoroughly with soap and running water.
2. If the liquid crystal fluid gets into your eye, flush the eye with clean water for at least 15 minutes. Seek medical care.
3. If the liquid crystal fluid is ingested, flush your mouth thoroughly with water. Drink large quantities of water and induce vomiting. Seek medical care.

### **Safety Precautions**

Be sure to observe the following warnings. Failure to follow these safety instructions and warnings may result in a serious accident.

- Do not operate the Sportster 6 in a way that might divert your attention from driving safely. As a driver, you are responsible for safely operating your vehicle in accordance with traffic safety laws at all times.

- Do not install the unit where it may obstruct your view through the windshield, or of your vehicle's indicator displays.
- Do not install the unit where it may hinder the function of safety devices such as an airbag. Doing so may prevent the airbag from functioning properly in the event of an accident.
- Be sure the unit is installed as described in these installation instructions and the instructions which accompany each accessory kit. SIRIUS Satellite Radio is not responsible for issues arising from installations which were not installed according to the instructions.
- To avoid short circuits, do not open the unit, and never put or leave any metallic objects (coins, tools, etc.) inside the unit.
- If the unit emits smoke or unusual odors, turn the power off immediately, and disconnect the unit from any power source.
- Do not drop the unit or subject it to strong shocks.
- If the unit doesn't seem to be working properly, turn the unit off, wait 10 seconds, and then turn it on again.
- The installation and use suggestions contained in this manual are subject to any restrictions or limitations that may be imposed by applicable law. The purchaser should check applicable law for any restrictions or limitations before installing and/or operating this unit.

## Warnings

### **Operating Temperature**

The radio is designed to operate between -20° to +85° C (-4° to +185° F). Avoid leaving the radio in a vehicle or elsewhere where the temperature may fall outside this range. Extreme temperatures or extreme temperature fluctuations can degrade the performance of the LCD display screen, and possibly damage it.



### **Cleaning and Maintenance**

If the radio or accessories become dirty, turn the power off and wipe them clean with a soft cloth. Do not use hard cloths, strong cleaning fluids, paint thinner, alcohol, or other volatile solvents to clean. These may cause damage to the radio.

### **PowerConnect Power Adapter**

The Vehicle Dock cannot be powered directly from a vehicle's 12VDC power system. It must be powered from the vehicle's cigarette lighter or similar power port using the included *PowerConnect* Power Adapter or an equivalent DC power adapter (see your local electronics dealer). Connecting the Vehicle Dock directly to the vehicle's 12VDC power system may result in damage to the Vehicle Dock or SIRIUS radio, or both.

# Copyrights & Trademarks

© 2010 Sirius Canada Inc. "SIRIUS", the SIRIUS dog logo, channel names and logos are trademarks of SIRIUS XM Radio Inc. and are used under licence. "NFL" and the NFL Shield design are trademarks of the National Football League. "BBC" and "Radio One" are trademarks of the British Broadcasting Corporation and are used under license. BBC logo © 1996. Radio 1 logo BBC. Elvis Radio logo © EPE Reg. U.S. Pat & TM off. All other trademarks, service marks, images and logos are property of their respective owners and are displayed in this publication with permission. All Rights Reserved. Required subscription sold separately.

™ "Sportster" is a trademark of SIRIUS Satellite Radio.

Portions of the software on this radio are licensed under the eCos License. Distribution of eCos requires that the eCos source code be made available to SIRIUS Satellite Radio customers. The eCos License and eCos source code are available to the public at <http://www.sirius.com/ecoslicense>.

SIRIUS Satellite Radio reserves all rights to all radio software not covered under the eCos license. This includes all portions of radio software that were not distributed to SIRIUS as part of the eCos operating system.

Hardware, subscription and activation fee required. For full Terms & Conditions, visit [sirius.ca](http://sirius.ca). Prices and programming are subject to change. Equipment and subscription sold separately. Installation required with some equipment. Radio is not for sale or use outside of Canada.

# Package Contents

The following items are included with your Sportster 6 radio:

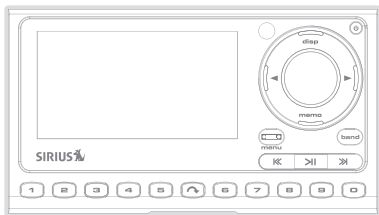

**Sportster 6 Radio**



**Remote Control**

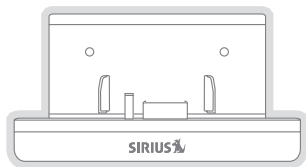

**PowerConnect Vehicle Dock**



**Aux In Cable**

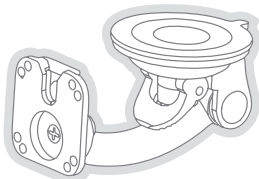

**Suction Cup Mount**

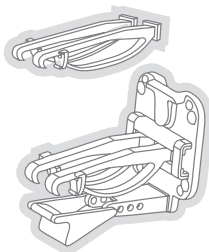

**Vent Mount &  
Extended Vent Hooks**

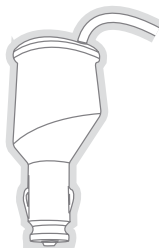

**PowerConnect  
Power Adapter**



**Magnetic  
Antenna**



**Antenna  
Cover/Tail**



**Mounting  
Screws**



**Alcohol  
Wipe**

Unpack your Sportster 6 carefully and make sure that everything shown is present. If anything is missing or damaged, or if your Sportster 6 radio fails to operate, notify your dealer immediately. It is recommended that you retain the original carton and packing materials in case you need to ship your radio in the future.

# Vehicle Installation

## Installing the *PowerConnect* Vehicle Dock

When installing the *PowerConnect* Vehicle Dock in your vehicle, choose a location that will not block your vision, interfere with the vehicle controls, or obstruct the air bag. The location should be easily accessible and provide good visibility of the display, and should not be located where it will be in direct sunlight which will affect the visibility of the radio's display screen.

The mounting accessories necessary to install the dock in a vehicle are provided. *Figure 1* shows two examples of the SIRIUS radio mounted in a vehicle: **A** is the suction cup mount method, and **B** is the vent mount method using the vent mount clip.

**Note: The supplied suction cup mount and vent mount should work in most vehicles. If your installation requires a different mounting option, check with a local electronics retailer for other compatible mounts that are available separately.**

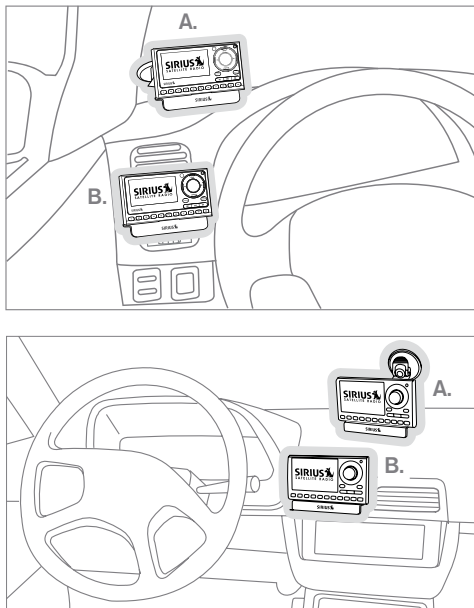

**Figure 1**

Depending upon the mounting location you select in your vehicle, the mount should be attached to the vehicle dock and installed as described in the following sections.

### Suction Cup Mount Method (A)

The suction cup mount may be attached to your vehicle's windshield. To mount the dock using the suction cup mount, assemble the mount as follows:

1. Attach the dock to the suction cup mount using the provided screws. (See *Figure 2*.)
2. Clean the area where you are attaching the suction cup with the supplied alcohol wipe.

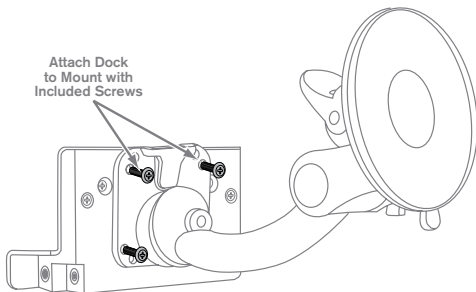
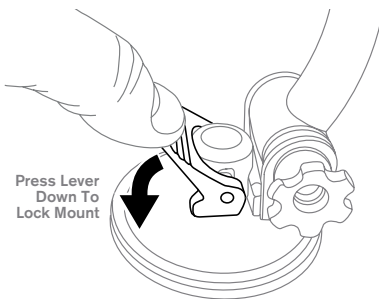

Figure 2



3. Be sure the cam lever is up (as shown in *Figure 3*) and position the suction cup mount on the windshield or other location you have chosen. Press the cam lever all the way down towards the base of the mount until it locks to firmly adhere the suction cup. (To unlock the suction cup, lift the lever up.)



**Figure 3**

## Vent Mount Method (B)

To mount the dock using the vent mount method, install the vent mount as follows:

1. If the vent louvers in your vehicle are recessed, you may need to use the longer vent hooks with the vent mount. Refer to *Figure 4* and install the longer vent hooks into the vent mount. Be sure to observe the orientation of the vent hooks as shown.
2. Attach the vent mount to the vehicle dock using the provided screws. (See *Figure 5*.)

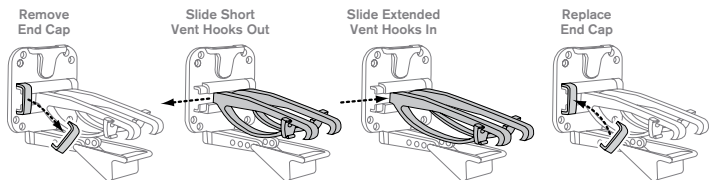

Figure 4

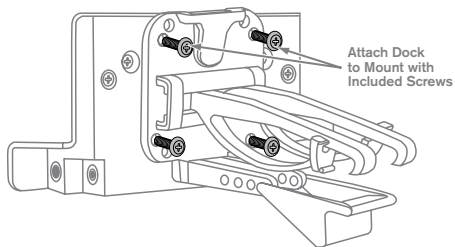

Figure 5

3. Refer to *Figure 6* and attach the vent mount to a heating/air conditioning vent in your vehicle. Position the two tension springs **A** against a vent louver **B**. Then push the vent mount into the vent, far enough so that the hooks **C** drop down and hook the rear of the vent louver (see *Figure 7*). Once the hooks have grasped a vent louver, the tension springs **A** will keep the vent mount hooked to the louver.

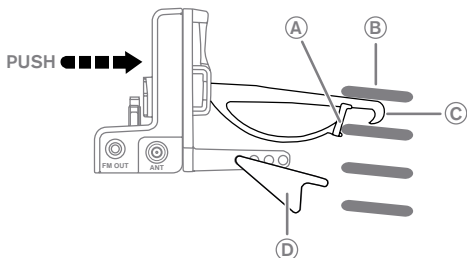

Figure 6

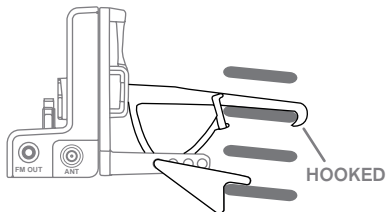
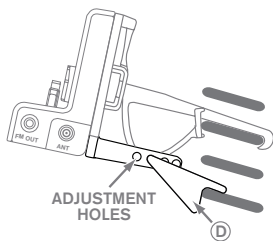

Figure 7

4. The angle of the dock may be changed by changing the position of foot **D** on the vent mount to a different adjustment hole. (See *Figure 8*.)



**Figure 8**

# Installing the Magnetic Antenna

## Caution

Because adhesive is used in the installation of the Rubber Antenna Cover/Tail, we recommend that you install the antenna at or above room temperature (68° F). The adhesive on the Rubber Cover/Tail may not adhere properly to the vehicle roof at temperatures lower than this. Warmer temperatures will also make it easier to route of the antenna cable through the rubber molding around the windows and in other areas in the vehicle. Maximum adhesion usually occurs within 72 hours at room temperature, so you should avoid car washes as well as other contact with the antenna and Rubber Cover/Tail during this 72 hour period.

## Warning

Be sure not to cut, damage, or puncture the external jacket of the antenna cable during the installation procedure. Damage to the antenna cable can degrade the SIRIUS signal or make it unavailable, and can also cause water to intrude via the cable into the antenna causing the antenna to fail.

Do not lengthen or shorten the antenna cable by cutting it. Doing so will cause the antenna to not function properly.

## Installation

Installing the magnetic antenna consists of two steps:

- Mounting the magnetic antenna and Rubber Antenna Cover/Tail on the vehicle
- Routing the antenna cable through the vehicle to the Vehicle Dock

## ANTENNA MOUNTING

The SIRIUS Magnetic Mount Vehicle Antenna has a strong magnetic mount designed to hold it in place during normal driving conditions (highway/city). This also makes the antenna easy to remove for transferring it to other vehicles.

Figure 9 shows the optimal mounting location for the antenna on several types of vehicles. These mounting positions should be observed when installing the antenna:

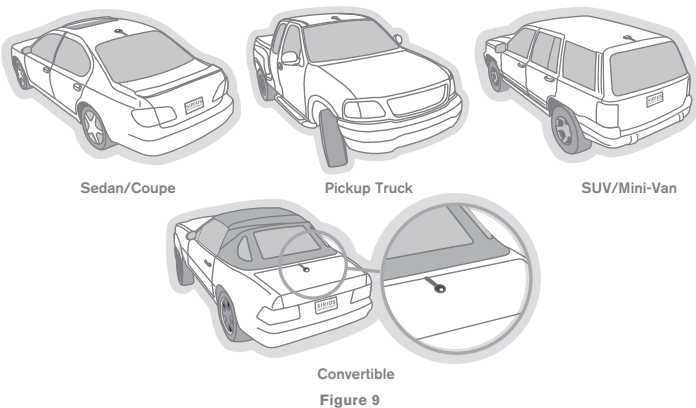

- **Sedan/Coupe/SUV/Mini-Van:** Install the antenna at the rear center of the roof, near the rear window.
- **Pickup Truck:** Install the antenna at the front center of the roof, near the windshield.
- **Convertible:** Install the antenna at the front center of the trunk lid, near the rear window.

The SIRIUS antenna needs to have an **unobstructed area of 3 inches by 3 inches around it**. It is important to mount the antenna where no obstructions will block the antenna from receiving the SIRIUS signal. Objects which can obstruct the antenna could be a roof rack, a sunroof, a roof-mounted cargo container, another antenna, etc. If your vehicle has a potential obstruction, be sure that the SIRIUS antenna is mounted at least 3 inches away from it (but no closer than 3 inches from the roof edge, or trunk lid in the case of a convertible).

**Note:** Read the **DO** and **DO NOT** installation tips beginning on page 32 for additional antenna installation information.

Follow this procedure to mount the antenna:

1. Select an appropriate mounting position for your type of vehicle that has an unobstructed area of 3 inches by 3 inches around the antenna.
2. Attach the Rubber Cover/Tail to the antenna, as shown in *Figure 10*, and press the antenna cable into the rubber cover/tail. The Rubber Cover/Tail will help to position the antenna the correct distance from the edge of the roof or trunk lid.

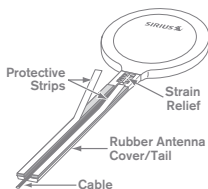

**Magnetic Antenna  
(Upside-Down)**

**Figure 10**

3. Clean the surface area of the vehicle where you will be installing the antenna with the alcohol prep pad.

4. Peel the protective material from the adhesive strips (see *Figure 10*, on page 23) and press the rubber Cover/Tail firmly into place on the vehicle.
5. Double check that the location of the antenna and rubber cover/tail are correct, and continue to press firmly down on the Rubber Cover/Tail for another 30 seconds. At room temperature (68° F), maximum adhesion usually occurs within 72 hours. During this period, avoid car washes and other contact with the antenna and the Rubber Antenna Cover/Tail.

### **CABLE ROUTING**

After you have mounted the antenna you can route the antenna cable to the SIRIUS Vehicle Dock. Separate antenna cable routing procedures are provided for each type of vehicle: Sedan/Coupe, Pickup Truck, SUV/Mini-Van and Convertible.

Note that additional breakout illustrations for each step of the antenna cable routing procedures can be found on the SIRIUS website at [sirius.ca](http://sirius.ca). Click on the **Install/Activate** link and then follow the link for the **Car Installation Tips**.



## Sedan/Coupe Antenna Cable Routing Procedure

Figure 11 shows how the antenna cable should be routed from the antenna to your SIRIUS radio in a sedan/coupe.

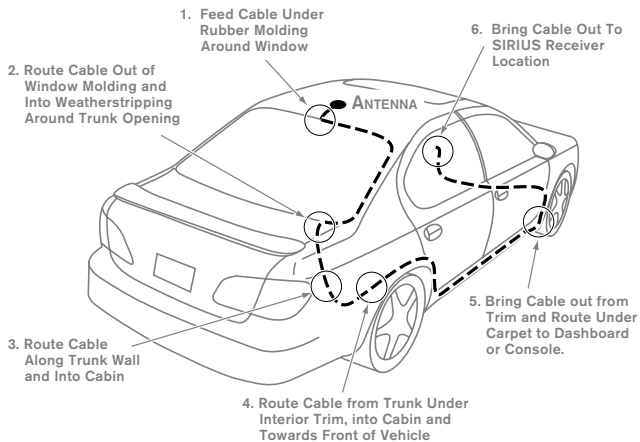

Figure 11

Follow these detailed cable installation instructions:

1. Feed the cable from the antenna underneath the rubber molding around the rear window. Use a plastic putty knife or similar object to lift the rubber molding around the rear window and tuck the antenna cable underneath the molding. Route the antenna cable around and down the window to the lowest point. If your rear window does not have rubber molding, SIRIUS recommends consulting with a professional installer.

2. Route the antenna cable out of the window molding and into the rubber weather stripping around the trunk opening. Lift the weather stripping from the opening and tuck the cable inside it, then replace the weather stripping. To avoid sharp bends in the cable, run the cable inside of the weather stripping for a few inches, then remove the cable from the weather stripping inside of the trunk. Keep the cable away from hinges, gears, etc., that could damage it.
3. Route the cable out from the rubber weather stripping and along the trunk wall. Continue routing the cable into the cabin through a conduit or along an existing wiring harness.
4. Route the cable through the main cabin area under the interior trim, towards the front of the vehicle. Use the plastic putty knife to lift the plastic trim just enough to tuck the cable under underneath. Avoid side airbag locations on back pillars and above the doors. (Airbag locations are marked with "SRS" logos.) Be careful not to crimp or cut the cable.
5. Bring the cable out from the trim near the firewall and route it under the carpet toward the dashboard or console. Coil any excess cable in a hidden location, such as under the carpet, keeping it away from any vehicle pedals or controls. Secure the excess cable with wire ties.
6. Bring the end of the cable out at the SIRIUS Vehicle Dock location. Leave yourself enough cable so you can easily connect it to the antenna connector on the Vehicle Dock.

## Pickup Truck Antenna Cable Routing Procedure

Figure 12 shows how the antenna cable should be routed from the antenna to your SIRIUS radio in a pickup truck.

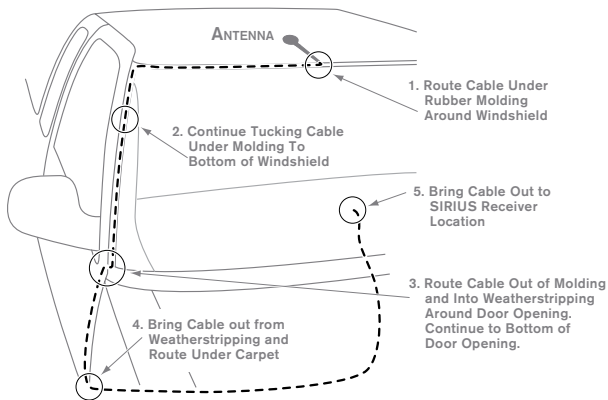

Figure 12

Follow these detailed cable installation instructions:

1. Use a plastic putty knife or similar tool to lift the rubber molding around the windshield and tuck the antenna cable underneath it.
2. Continue tucking the cable underneath the windshield molding around the windshield to the lowest corner.

3. At the lowest corner of the windshield, route the cable out of the windshield molding and into the rubber weather stripping around the door opening. Lift the weather stripping from the opening and tuck the cable inside it, then replace the weather stripping. Run the cable inside of the weather stripping to the bottom of the door opening.
4. Pull the cable out of the weather stripping at the bottom of the door opening and route it under the carpet toward the dashboard. Coil any excess cable in a hidden location, such as under the carpet, keeping it away from any vehicle pedals or controls. Secure the excess cable with wire ties.
5. Bring the end of the cable out at the SIRIUS Vehicle Dock location. Leave yourself enough cable so you can easily connect it to the antenna connector on the Vehicle Dock.

#### **SUV/Mini-Van Antenna Cable Routing Procedure**

*Figure 13* (on page 29) shows how the antenna cable should be routed from the antenna to your SIRIUS radio in an SUV or a Mini-Van.

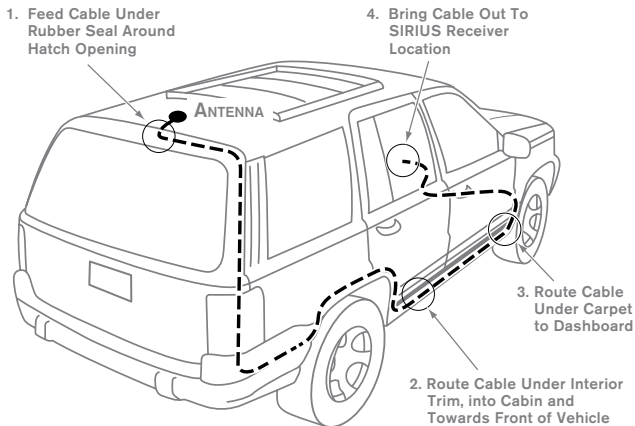

**Figure 13**

Follow these detailed cable installation instructions:

1. Feed the antenna cable underneath the rubber weather stripping of the rear tailgate window/door and route the cable along the rear hatch. Lift the weather stripping from the opening and tuck the cable inside it, then replace the weather stripping. Pull the cable out from weather stripping and route it into the cabin under the interior trim. Avoid hinges or gears that could crimp or cut the cable.
2. Route the cable through the SUV's main cabin area under the interior trim, towards the front of the vehicle. Use a plastic putty knife to lift the plastic trim just enough to tuck the cable under underneath. Avoid side airbag locations on back pillars and above the doors. (Airbag locations are marked with "SRS" logos.) Be careful not to crimp or cut the cable.

3. Bring the cable out from the trim near the firewall and route it under the carpet toward the dashboard or console. Coil any excess cable in a hidden location, such as under the carpet, keeping it away from any vehicle pedals or controls. Secure the excess cable with wire ties.
4. Bring the end of the cable out at the SIRIUS Vehicle Dock location. Leave yourself enough cable so you can easily connect it to the antenna connector on the Vehicle Dock.

### Convertible Antenna Cable Routing Procedure

Figure 14 shows how the antenna cable should be routed from the antenna to your SIRIUS radio in a convertible.

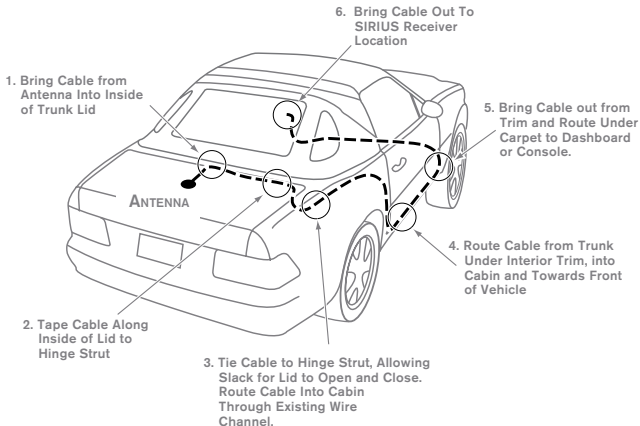

Figure 14

Follow these detailed cable installation instructions:

1. Bring the cable from the antenna into the trunk at the front edge of the trunk lid. Keep any bends in the cable loose. Tape or tie the cable along the inside of the trunk lid to the trunk lid hinge strut.
2. Allow enough slack in the cable so the trunk lid can easily open and close and keep the cable away from hinges, gears, etc., that could crimp or cut it. Route the cable along the trunk wall and into the cabin through a conduit or along an existing wiring harness.
3. Route the cable through the main cabin area under the interior trim, towards the front of the vehicle. Use a plastic putty knife to lift the plastic trim just enough to tuck the cable under underneath. Avoid side airbag locations on back pillars and above the doors. (Airbag locations are marked with "SRS" logos.) Be careful not to crimp or cut the cable.
4. Bring the cable out from the trim near the firewall and route it under the carpet toward the dashboard or console. Coil any excess cable in a hidden location, such as under the carpet, keeping it away from any vehicle pedals or controls. Secure the excess cable with wire ties.
5. Bring the end of the cable out at the SIRIUS Vehicle Dock location. Leave yourself enough cable so you can easily connect it to the antenna connector on the Vehicle Dock.

## TIPS

The following **DO** and **DO NOT** antenna mounting tips illustrate how to install the antenna for optimal performance, and also illustrate where the antenna should not be installed.

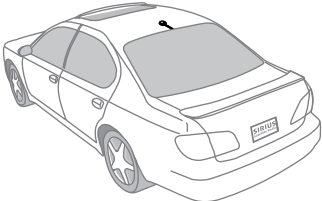
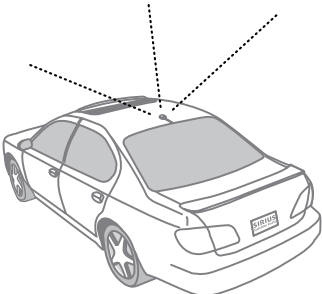
<b>DO</b>	Mount the antenna on the roof, at least 3 inches from the edge.	 A line drawing of a car from a rear three-quarter view. A small black antenna is mounted on the roof, positioned towards the rear edge of the roofline.
<b>DO</b>	Mount the antenna on the roof where it has a clear view of the sky in all directions.	 A line drawing of a car from a rear three-quarter view. An antenna is mounted on the roof. Three dashed lines radiate from the antenna in different directions, indicating a clear view of the sky.

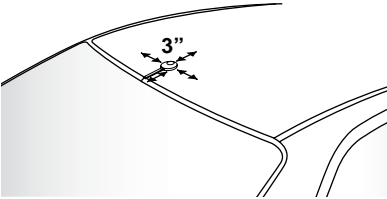
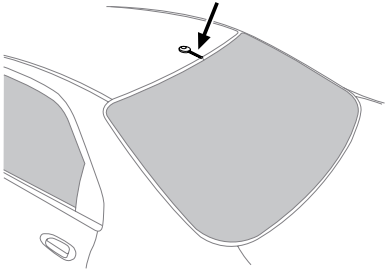

<b>DO</b>	Mount the antenna on the roof where it has at least 3 inches of clear space around it.	 A line drawing of a car's roof and rear window area. An antenna is shown mounted on the roof. A square with a diagonal line and the text "3\" data-bbox="595 185 665 235"/>
<b>DO</b>	Use the supplied Rubber Tail Cover to protect the antenna cable.	 A line drawing of a car's rear window and trunk area. A large, dark gray, trapezoidal Rubber Tail Cover is shown being applied to the antenna cable. An arrow points to the cover, and a small circular detail of the cover's edge is shown below the main drawing. The antenna cable is shown entering the trunk area from the rear window.

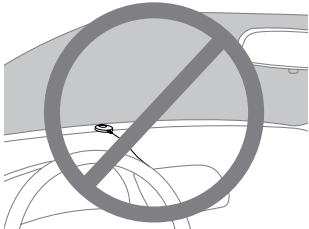
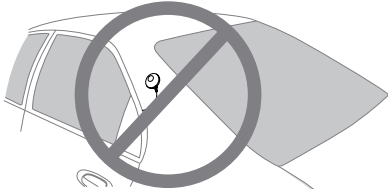
<b>DO NOT</b>	Don't mount the antenna inside the vehicle, for example, on the dashboard.	
<b>DO NOT</b>	Don't mount the antenna on any of the vehicle's front, back or side pillars.	

**DO  
NOT**

Don't mount the antenna close to a roof rack. Adjust the rack so it's further away from the antenna or move the antenna closer to the center of the roof.

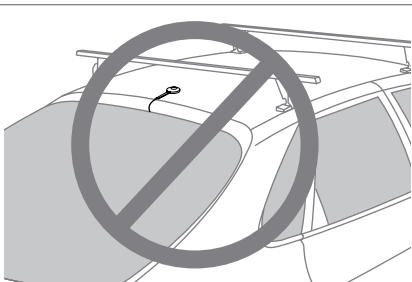

**DO  
NOT**

Don't mount the antenna close to another antenna. Mount it at least 3 inches away.

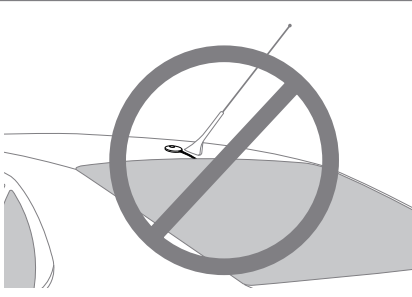

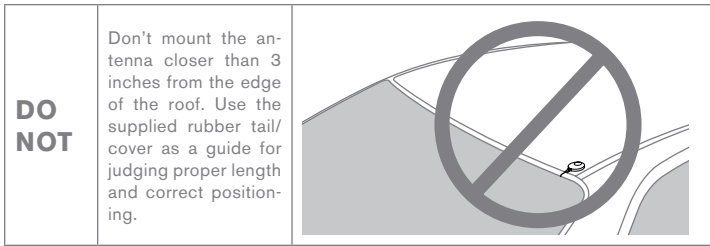

After you've routed the cable to the *PowerConnect Vehicle Dock*, connect the antenna cable to the ANT connection on the right side of the *PowerConnect Vehicle Dock*. (See *Figure 15*.)

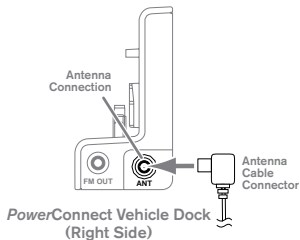

**Figure 15**

## Connecting the *PowerConnect* Power Adapter

Connect the provided *PowerConnect* Power Adapter to the 5VDC connector on the left side of the *PowerConnect* Vehicle Dock. (See *Figure 15*.)

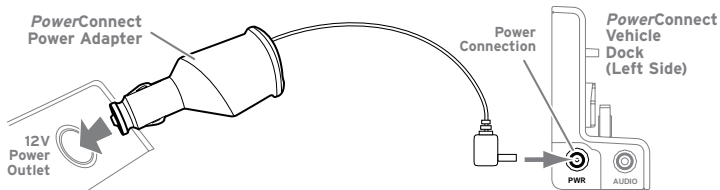

Figure 15

**Note:** Do not power the *PowerConnect* Vehicle Dock directly from your vehicle's 12VDC power system without using the *PowerConnect* Power Adapter. This could damage the *PowerConnect* Vehicle Dock, your SIRIUS Radio or both.

## Connecting Your SIRIUS Radio to Your Vehicle's Audio System

To play audio through your vehicle's stereo or FM radio, decide on one of the following audio connection options:

- **Option 1: Best:** Use the included **Aux In Cable** if your vehicle's stereo system has an auxiliary input connection. Refer to your vehicle's owners manual to find the location of the auxiliary input jack, or consult the vehicle dealer.

**TIP!** The auxiliary input jack may be located on the face plate of the vehicle radio, on the back of the radio, anywhere on the front dash panel, inside the glove compartment, or inside the center console in between the front seats.

- **Option 2: Better:** Use a **Cassette Adapter** if your vehicle has a built-in cassette player. Cassette Adapters are sold separately and can be purchased from an electronics retailer, or go to [shop.sirius.ca](http://shop.sirius.ca).
- **Option 3: Good:** Use the **PowerConnect** feature in the Sportster 6. *PowerConnect* plays the audio through your vehicle's FM radio.
- **Option 4: Best:** Use the **FM Direct Adapter**. If none of the previous three audio connection options will work in your vehicle, then you will need to use the FM Direct Adapter (FMDA25C) (sold separately). The FMDA25C needs to be installed by a professional installer and directly connects your radio to your vehicle's FM radio. To learn more, check with the retailer where you bought your radio, or go to [shop.sirius.ca](http://shop.sirius.ca).

Follow the installation instructions in the next several sections for the audio connection option that you have selected.

### Option 1: Aux In Cable Installation Instructions

1. Plug one end of the Aux In Cable into the **green AUDIO** connector on the dock. (See *Figure 16*.)

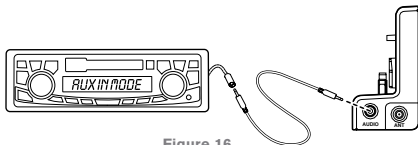

Figure 16

2. Plug the other end into the auxiliary input jack connection of your vehicle's stereo system.
3. Insert your Sportster 6 into the dock, aligning the radio against the rear of the dock so that the rails on the dock fit into the mounting slots in the back of the radio. (See *Figure 17*.)

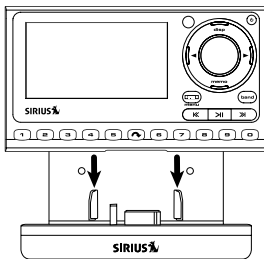

Figure 17

4. Power on your Sportster 6 by pressing the POWER button. (See *Figure 18*.)
5. Be sure the vehicle is outside and the antenna has a clear view of the sky. Verify that you are receiving the SIRIUS signal. There should at least be one bar on the

lower left corner of the main display screen that denotes antenna signal strength. You can also press and hold MENU and then rotate the ROTARY knob to scroll and highlight SIGNAL INDICATOR. Press the SELECT button. The Satellite and Terrestrial bars show the strength of the signal being received. (See *Figure 19*.) If the signal reception is good, press and hold MENU to return to the main display screen.

6. Ensure that the Sportster 6 is tuned to channel 184. Upon power up, the Sportster 6 should tune to channel 184 by default, when it's not yet activated. If it's not on channel 184, refer to "Operation" on page 55 to learn about how to tune a channel.
7. Turn on your vehicle's stereo system. Set it to play input from the auxiliary input source.
8. You should hear SIRIUS channel 184 through your vehicle's stereo system. You are now ready to subscribe your Sportster 6.
9. The audio level output of the Sportster 6 can be increased or decreased as necessary to match the audio levels of other sources in your vehicle. Refer to "Audio Level" on page 87.

If the signal reception is good, but there is no audio when tuned to channel 184, be sure the vehicle's stereo system is set to the correct source, i.e., auxiliary input source (step 7). Also be sure that the audio level is set high enough to be heard (step 9). Refer to "Troubleshooting" on page 102 for additional help.

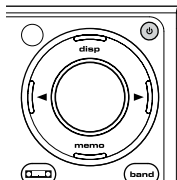

Figure 18

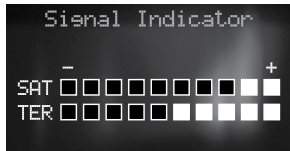

Figure 19



## Option 2: Cassette Adapter Installation Instructions

1. Plug the Cassette Adapter into the **green AUDIO** connector on the dock. (See *Figure 20*.)

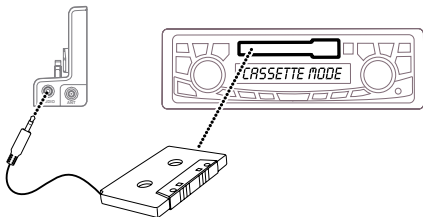

Figure 20

2. Insert the Cassette Adapter in the vehicle's cassette deck. You may need to turn on your vehicle's stereo system in order to do so.
3. Insert your Sportster 6 into the dock, aligning the radio against the rear of the dock so that the rails on the dock fit into the mounting slots in the back of the radio. (See *Figure 21*.)

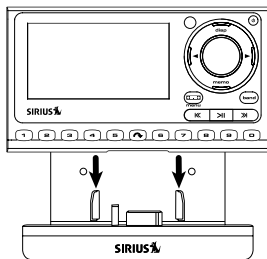

Figure 21

- Power on your Sportster 6 by pressing the POWER button. (See *Figure 22*.)
- Be sure the vehicle is outside and the antenna has a clear view of the sky. Verify that you are receiving the SIRIUS signal. There should be at least be one bar on the lower left corner of the main display screen that denotes antenna signal strength. You can also press and hold MENU and then rotate the ROTARY knob to scroll and highlight SIGNAL INDICATOR. Press the SELECT button. The Satellite and Terrestrial bars show the strength of the signal being received. (See *Figure 23*.) If the signal reception is good, press and hold MENU to return to the main display screen.

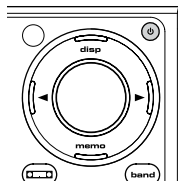

Figure 22

- Ensure that the Sportster 6 is tuned to channel 184. Upon power up, the Sportster 6 should tune to channel 184 by default, when it's not yet activated. If it's not on channel 184, refer to "Operation" on page 55 to learn about how to tune a channel.

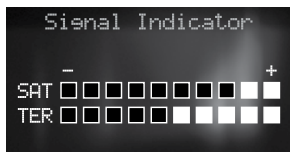

Figure 23

- If you haven't done so, turn on your vehicle's stereo system. Set it to play input from the cassette source.
- You should hear SIRIUS channel 184 through your vehicle's stereo system. You are now ready to subscribe your Sportster 6.
- The audio level output of the Sportster 6 can be increased or decreased as necessary to match the audio levels of other sources in your vehicle. Refer to "Audio Level" on page 87.

If the signal reception is good, but there is no audio when tuned to channel 184, be sure the vehicle's stereo system is set to the correct source, i.e., cassette source (step 7). Also be sure that the audio level is set high enough to be heard (step 9). Refer to "Troubleshooting" on page 102 for additional help.

### Option 3: PowerConnect Installation Instructions

1. Insert your Sportster 6 into the dock, aligning the radio against the rear of the dock so that the rails on the dock fit into the mounting slots in the back of the radio. (See *Figure 24*.)
2. Power on Sportster 6 radio by pressing the POWER button. (See *Figure 25*.)
3. Be sure the vehicle is outside and the antenna has a clear view of the sky. Verify that you are receiving the SIRIUS signal. There should at least be one bar on the lower left corner of the main display screen that denotes antenna signal strength. You can also press and hold MENU and rotate the ROTARY knob to scroll and highlight SIGNAL INDICATOR. Press the SELECT button. The Satellite and Terrestrial bars show the strength of the signal being received. (See *Figure 26*.) If the signal reception is good, press and hold MENU to return to the main display screen. You are ready to make the audio connection.
4. You'll first need to find an available FM channel. An available FM channel is one that's not being used by an FM radio station in your area. When you tune your FM radio to an available channel, you should only hear static or silence – not talk or music. We recommend one of the following methods to find an available FM channel:
  - a. Use the SIRIUS FM Channel Finder at

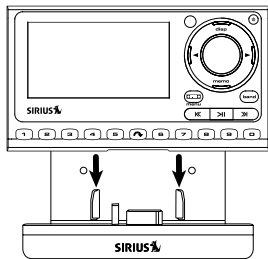

Figure 24

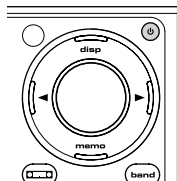

Figure 25

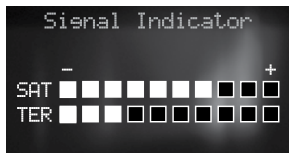

Figure 26

<http://sirius.ca/en/install/frequency.aspx>. Go to the website and enter your zip code. The Channel Finder will suggest a list of available FM channels in your area. For convenience, write down or print out the list.

OR

- b. Manually tune through your local FM channels on your vehicle's FM radio. Locate and create a list of channels that aren't being used by any FM radio station. Write down the list. Once you have created your list of available FM channels, you will need to find the one that provides the best match for your Sportster 6.

**TIP!** You'll need to use the 'Manual' tune function on your vehicle's FM radio to tune through every FM channel one-by-one. Turn on your vehicle's FM radio. Start at 88.1 and use the 'Manual' tune function on your vehicle's FM radio to tune through each FM channel one-by-one (88.1 followed by 88.3 etc.) to locate channels that aren't being used by a local FM radio station. Write down each FM channel that has only static or silence on it, until you reach 107.9.

- 5 Ensure that the Sportster 6 is tuned to channel 184. Upon power up, the Sportster 6 should tune to channel 184 by default, when it's not yet activated. If it's not on channel 184, refer to "Operation" on page 55 to learn about how to tune a channel.
- 6 Pick the first FM channel on your list from step 4. Turn on your vehicle's FM radio (if you have not already done so) and tune it to this FM channel.

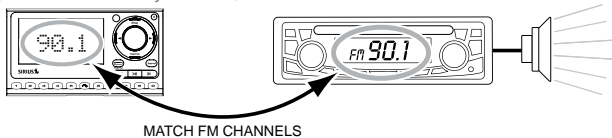

Figure 27

- 7 Set your Sportster 6 to transmit on the same FM channel that you have selected in step 4:
  - I. Press and hold MENU until MENU OPTIONS is displayed. (See *Figure 28*.)

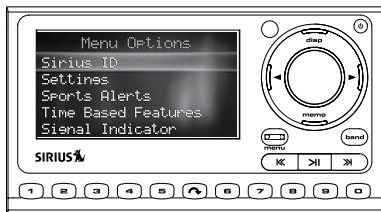

Figure 28

- II. Rotate the ROTARY knob to highlight SETTINGS and press the **Select** button.
  - III. FM Transmitter will be highlighted. Press the SELECT button. (See Figure 29.)
  - IV. SET FM PRESETS will be highlighted. Press the SELECT button. (See Figure 30.)
  - V. Rotate the ROTARY knob to scroll and highlight the storage location FM2. Press the SELECT button. (See Figure 31.)
  - VI. Tune to the FM channel you found in step 3. Rotate the ROTARY knob to scroll and highlight the desired FM channel. Press the SELECT button to select the FM channel. (See Figure 32.)
  - VII. The FM channel you selected will be confirmed on the display screen. The Sportster 6 will tune to the FM channel.
- 8 You should hear SIRIUS channel 184 through your vehicle's FM radio. If you are satisfied with the sound quality, you're done! You are now



Figure 29



Figure 30



Figure 31



Figure 32

ready to subscribe your Sportster 6.

- 9 If the selected FM channel doesn't work well for you, work down the list of FM channels until you find one that allows you to hear SIRIUS clearly. Each time, you will need to tune your vehicle's FM radio to the FM channel and then set your Sportster 6 to transmit on the same FM channel (steps 6 & 7).

If the signal reception is good, but there is no SIRIUS audio when tuned to channel 184, verify that both the radio and your vehicle's FM radio are tuned to the same FM channel (steps 6 & 7). Also ensure the chosen FM channel is a suitable one to use in your area (step 4). Verify that nothing is plugged into the **AUDIO** connector on the *PowerConnect* Vehicle Dock. Refer to "Troubleshooting" on page 102 for additional help.

#### Option 4: FM Direct Adapter (FMDA) Installation

The FMDA needs to be installed by a professional installer. Professional installation can help improve your radio's reception and significantly reduce the visibility of wires. To learn more, check with the retailer where you bought your radio, or go to [shop.sirius.ca](http://shop.sirius.ca).

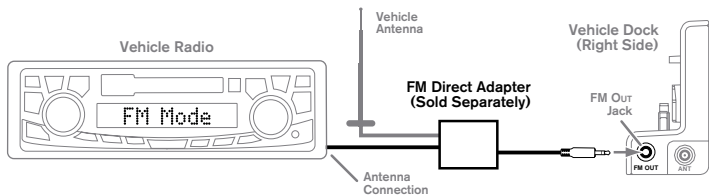

## Subscribing to the SIRIUS Service

Before you can listen to the SIRIUS service, you need to subscribe to the SIRIUS Satellite Radio service. To subscribe, do the following:

1. Be sure that your Sportster 6 is correctly installed, is properly docked in the Vehicle Dock, and that the antenna is oriented to receive the SIRIUS signal.
2. Turn on the Sportster 6. After the startup sequence, it will update the SIRIUS channel line-up. Wait until the channel updates have completed before pressing any buttons.
3. Once the channels have been updated, the radio will automatically tune to channel 184 and the display will change to *Call 1-888-539-SIRIUS to Subscribe*. You will not be able to listen to any other channels until you activate your SIRIUS subscription.
4. Use the Sportster 6 Knob to tune to channel 0 to display your Sportster 6's unique 12-digit SIRIUS ID Number (SID). You can also tune to channel 0 by using the remote control: Press the SELECT button, then the 0 (zero) button, and then the SELECT button again. The SID number is also available on your Sportster 6's packaging, and may also be accessed by pressing the MENU button and selecting SIRIUS ID. Write the SID number down.
5. Have your credit card handy and contact SIRIUS on the Internet at: <https://activate.siriuscanada.ca/> and follow the prompts to activate your subscription. You can also call SIRIUS toll-free at **1-888-539-SIRIUS** (1-888-539-7474).
6. When you have successfully subscribed to the SIRIUS service your Sportster 6 will display an alert. To continue, press the Knob.

You are now ready to begin enjoying SIRIUS Satellite Radio's digital entertainment, and can tune to other channels!

# Controls

## Sportster 6 Front Panel

Figure 33 and the section following identify and describe the Sportster 6's buttons and controls.

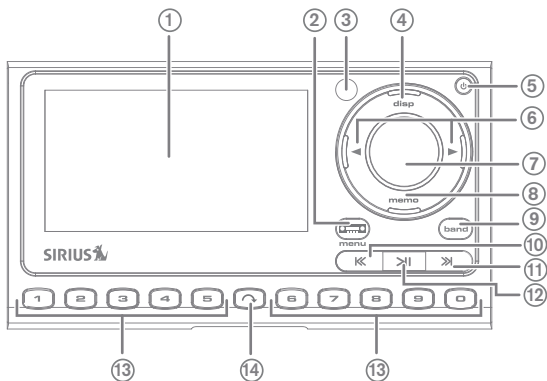

Figure 33



1. **Color LCD Display Screen:** Provides information about the Sportster 6's operation, the program that is playing and other programming that is available.
2. **FM Presets/MENU Button:** Lets you select between the different FM preset frequencies used by the Sportster 6's built-in internal FM transmitter. Press-and-hold accesses Menu options to make setup and feature changes.
3. **IR Receiver:** Receives IR signals from the included remote control.
4. **Display (DISP) Button:** Pressing and releasing this button changes the text size of artist names and song titles on the display screen. Pressing and holding this button displays the last screen viewed in the Channel List mode (see page 55).
5. **Power Button:** Turns the Sportster 6 ON and OFF.
6. **Category Buttons:** Press-and-release navigates through the CATEGORY LIST screens which display the SIRIUS channel categories. Pressing and holding the buttons increase or decrease the display's brightness, or lets you adjust the Auto Brightness settings, depending on the option selected in the Menu Options (see page 81).
7. **Rotary Knob/Select Button:** Rotating the Knob navigates through the different display screens; pressing the Knob makes selections of items highlighted on the display screen. Rotating clockwise increases the channel number (down the list), and moves down when in a menu list; rotating counterclockwise decreases the channel number (up the list), and moves up in when in a menu list. When not in a menu or list, pressing the Knob selects the channel entered using the Preset Number buttons.
8. **Memory (MEMO) Button (S-Seek Function):** Pressing and releasing this button saves artist names and song titles. You can store up to 30 artist/song title combinations, including favourite teams and traffic channels. Pressing and holding the MEMO button will enter the recall mode, displaying the stored artist/song titles.
9. **Band Button:** Pressing and releasing this button switches between the preset banks A, B, and C, which hold 10 presets each for a total of 30. Pressing and holding this button switches to the My PRESETS category, which lets you see what artists and songs are playing on each of your stored presets.

- 10. **Rewind Button:** Used to rewind through content saved to Instant Replay. Pressing and releasing this button rewinds to the beginning of the song or program. Pressing and holding rewinds by time through the saved content.
- 11. **Fast-Forward Button:** Used to fast-forward through Instant Replay saved content. Pressing and releasing this button fast-forwards to the beginning of the next song or program. Pressing and holding fast-forwards by time through the saved content.
- 12. **Play/Pause Button:** Pauses and replays live or time-shifted content from the currently tuned channel. Pressing and holding this button displays the list of Saved content.
- 13. **Number Buttons (0 – 9):** Set and select preset channels. Also used to directly-select channels.
- 14. **Jump Button:** Jumps to a preset favourite channel. Pressing the button again returns back to the original channel.

## Remote Control Buttons

Figure 34 and the section following identify the remote control's buttons.

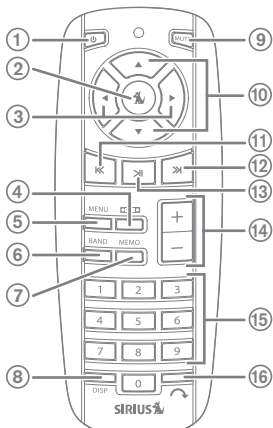

Figure 34

1. **Power Button:** Turns the Sportster 6 ON and OFF.
2. **Select Button:** Selects items highlighted in a list; hold-down to jump to the previously-received channel. When not in a menu or list, pressing the Select button selects the channel entered using the number buttons.
3. **Category Buttons:** Press and release navigates through the CATEGORY LIST screens

- which display the SIRIUS channel categories. Pressing and holding the buttons increase or decrease the display's brightness, or lets you adjust the Auto Brightness settings, depending on the option selected in the Menu Options (see page 81)
- 4. FM Presets Button:** Selects between the different FM preset frequencies used by the Sportster 6's built-in internal FM transmitter.
  - 5. MENU Button:** Accesses the MENU OPTIONS to make setup and feature changes.
  - 6. BAND Button:** Pressing and releasing this button switches between the preset banks A, B, and C, which hold 10 presets each for a total of 30. Pressing and holding this button switches to the My PRESETS category, which lets you see what artists and songs are playing on each of your stored presets.
  - 7. Memory (MEMO) Button (S-Seek Function):** Pressing and releasing this button saves artist names and song titles. You can store up to 30 artist/song title combinations. Pressing and holding will enter the recall mode, displaying the stored artist/song titles.
  - 8. Display (DISP) Button:** Pressing and releasing this button changes the text size of artist names and song titles on the display screen. Pressing and holding this button displays the last screen viewed in the Channel List mode (see page 55).
  - 9. MUTE Button:** Mutes the Sportster 6's audio output.
  - 10. Channel UP/DOWN Buttons:** Navigates through channels and display screens.
  - 11. Rewind Button:** Used to rewind through content saved to Instant Replay. Pressing and releasing this button rewinds to the beginning of the song or program. Pressing and holding rewinds by time through the saved content.
  - 12. Fast-Forward Button:** Used to fast-forward through Instant Replay saved content. Pressing and releasing this button fast-forwards to the beginning of the next song or program. Pressing and holding fast-forwards by time through the saved content.
  - 13. Play/Pause Button:** Pauses and replays live or time-shifted content from the currently tuned channel. Pressing and holding this button displays the list of Saved content.
  - 14. VOL+ / VOL- Buttons:** Increases or decreases the audio volume.
  - 15. Number Buttons (0-9):** Select channels directly and select preset channels.
  - 16. Jump Button:** Jumps to a preset favourite channel. Pressing the button again returns back to the original channel.

### Remote Control Battery Installation

To install the remote control battery, turn the remote control over and locate the battery cover near the bottom edge. Open the battery compartment and place the battery in the compartment with the + side of the battery facing up. Replace the battery cover on the remote control. See *Figure 35*.

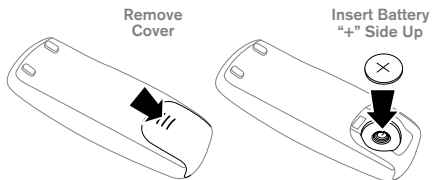

Figure 35

## PowerConnect Vehicle Dock Reference Guide

Figure 36 and the section following identify and describe the *PowerConnect Vehicle Dock's* features and connectors.

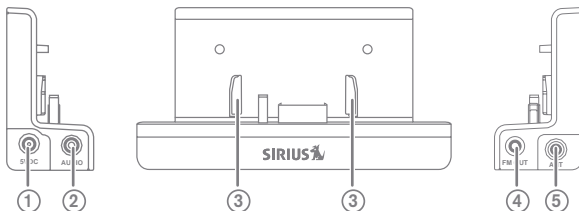

Figure 36

1. **DC5V Power Connector:** Power connection for the *PowerConnect Power Adapter* (see page 37).
2. **Audio Out (AUDIO) Connector:** Audio output for directly connecting to your vehicle's audio system (see pages 38 & 40).
3. **Docking Rails:** Fit-into slots in the back of the Sportster 6 to secure it while it is docked (page 37).
4. **FM OUT Connector:** FM output for use with the optional FM Direct Adapter (see page 45).
5. **Antenna (ANT) Connector:** Connection for the supplied magnetic antenna (see page 36).

# Operation

## Display Screen Information

Your Sportster 6's display screen provides information about the operation of the radio, such as the currently tuned channel, song or show being played, artist name, time and other information. This screen is referred to as the *Default* screen in this manual. *Figure 37* identifies the information displayed when listening to a typical broadcast.

Whenever you power the Sportster 6 ON, the previously-selected channel will automatically begin playing, and the currently-playing artist name and song title will be displayed.

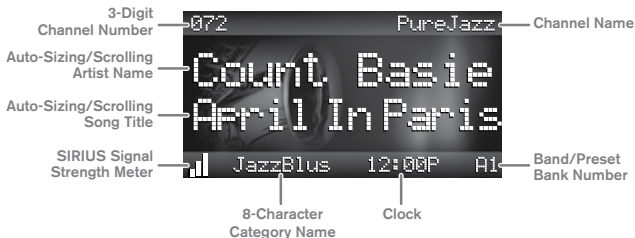

Figure 37

## Navigating Menus and Lists

The menu and list structures in your Sportster 6 are navigated by turning the Knob to scroll through a menu or list to highlight your choice, and then pressing the Knob to select the choice. When using the remote control, menus and lists are navigated by pressing the Channel UP/DOWN buttons, and then pressing the SELECT button to select the choice.

## Display (DISP) Button

Pressing and releasing the DISP button while the Default screen is displayed toggles between the 2-line artist name/song title text and large character displayed text (see *Figure 38*). The large character format will change the character size and cause the field to scroll from right to left. This feature is useful when viewing the display screen from a distance. Note that the displayed text will scroll only if the length of the artist or title cannot be viewed in its entirety.



2-Line Text Format



Large Text Format

Figure 38



Pressing and holding the DISP button for 1½ seconds enters the Channel List mode. Once the Channel List mode is active, repeatedly pressing and releasing the DISP button will cycle the display between these four screens (see *Figure 39*):

- **Combination List Screen:** Displays a list of channel numbers and names along with the currently-playing song titles and artist names on each channel.
- **Channel Name Screen:** Displays a list of channel numbers and channel names.
- **Artist Name Screen:** Displays a list of the currently-playing artists on each channel.

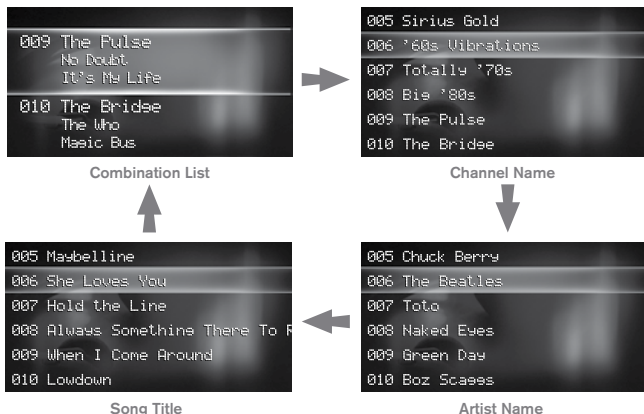

Figure 39

- **Song Title Screen:** Displays a list of the currently-playing songs on each channel.

To exit the Channel List mode and return to the Default screen, press and hold the Disp button.

## Search Modes (Preset, Category, Channel, Artist, Song Title)

You can search for and select music four ways on your Sportster 6: by category, by channel, by artist, and by song title.

### Searching Categories

If you want to browse different entertainment categories, press either Category button to activate the Category Search mode, which will display a list of the currently-playing artists and currently-playing song titles on the different channels of the currently-active category.

1. Use the Category buttons to scroll through the music and entertainment categories (see *Figure 40*). Note that your preset channels will be displayed as the MY PRESETS category.
2. When the category you want is displayed (for example, *Pop*), use the Knob to browse the available channels within the category (on the remote, use the Channel UP/DOWN buttons). When the desired channel is highlighted, press the Select button to select it. The channel will be selected and the display will revert to the Default screen for the selected channel.

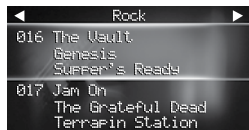
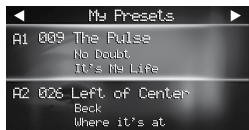
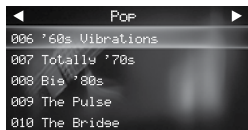
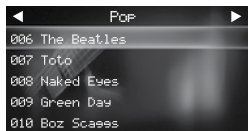

Figure 40

- Pressing the DISP button while in the category search mode will cycle between the category's channel names, the currently-playing artist names, and the currently-playing song titles to enable you to preview what is playing on other channels before making a selection. (See *Figure 41*) When the channel/artist/song you want is highlighted, press the Select button. The channel will be selected and the display will revert to the Default screen for the selected channel.
- To exit the Category mode without changing to a new channel, press and hold the DISP button for one second.



Channel Name



Artist Name

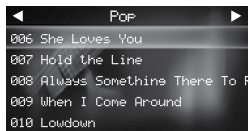

Song Title

**Figure 41**

### Searching Channels (Channel List Mode)

It is possible to search for a different channel while listening to your current channel. Be sure that the display shows the Default display screen prior to the following steps:

1. Press and hold the DISP button for two seconds to activate the channel list mode. The channel list screen be displayed, showing all available channels regardless of category. Pressing the DISP button while in the channel list mode will change between channel name, artist name, and song title (see *Figure 42*). You can use this feature to search for a specific artist, song, or show that may be playing at the time.
2. Turn the Knob to locate the channel you want (on the remote, use the Channel UP/DOWN buttons).
3. Press the Select button to select the channel. To exit the channel list mode without changing to a new channel, press and hold the DISP button for one second.

**Note: If you are in the channel list mode and viewing a sports category channel list (NFL® Zone, NHL® Zone, NBA® Zone), pressing the DISP button will toggle between the team names and the current score of any live play-by-play game.**

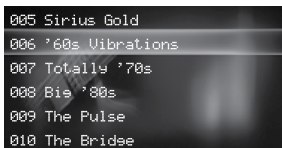

005 Sirius Gold  
006 '60s Vibrations  
007 Totally '70s  
008 Bis '80s  
009 The Pulse  
010 The Bridge

Channel Name

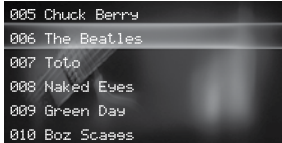

005 Chuck Berry  
006 The Beatles  
007 Toto  
008 Naked Eyes  
009 Green Day  
010 Boz Scaggs

Artist Name

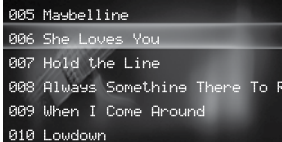

005 Maybelline  
006 She Loves You  
007 Hold the Line  
008 Always Something There To R  
009 When I Come Around  
010 Lowdown

Song Title

Figure 42

## Direct Tuning

Channels can be directly accessed by pressing and releasing the Knob and then using the 0 – 9 keys to enter the desired channel number (see *Figure 43*). Once the desired number has been entered, the channel will change and the display will revert to the Default screen for the selected channel. The Sportster 6 will tune the channel immediately if three numbers are entered (for example, "0", "0", "7"), but if just one or two digits are entered, the radio will tune to the new channel after three seconds.

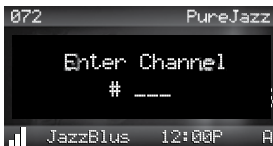

Figure 43

## Channel Presets

Channel presets lets you store up to 30 of your favourite channels as presets for quick access with the press of a button.

### Setting Channel Presets

Presets are stored in three banks, A, B, and C, each containing 10 channel presets.

1. Press the **BAND** button to activate the preset bank you want. The selected bank is shown in the lower right corner of the Default display screen (see *Figure 37*, on page 54).
2. Select the channel you want to preset.
3. Press and hold for two seconds the numbered preset button (0 – 9) in which you want to store the channel.

4. The selected preset number will flash and then remain lit on the display to show that it has been memorized.

If the preset button you selected already has a channel stored in it, the preset will be replaced with the newly stored channel.

### Recalling Channel Presets

The 10 presets in the active bank (A, B, or C) can be selected by pressing the 0 through 9 buttons.

1. Press the **BAND** button to activate the preset bank you want. The selected bank is shown in the lower right corner of the default display screen.
2. Press the desired preset button 0 – 9 to select the preset. The channel will change and the display will revert to the Default screen for the new channel, with the preset shown in the lower right corner.

Pressing and holding the **BAND** button displays the **MY PRESETS** screen (see below).

### MY PRESETS SCREEN

You can use the Knob to quickly see what's playing on all of your presets:

1. Press and hold the **BAND** button to activate the **MY PRESETS** screen (see *Figure 44*).

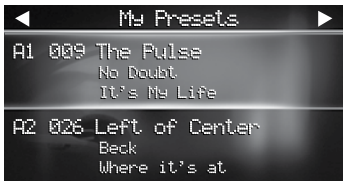

Figure 44

2. Turn the Knob in either direction to move through the presets. When the preset you want to listen-to is highlighted, press the Select button to tune to it.

Turning the Knob will cycle through all of the stored presets by preset bank and number (for example, A-1, A-2...B-1, B-2...C-1,C-2...). Continuing to turn the Knob after the last stored preset is displayed will return back to the first stored preset.

To exit the MY PRESETS screen and return to Default display screen, press and hold the BAND button.

## Jump Button

Your Sportster 6 features a special button called Jump. This button can be programmed to jump to a channel which is accessed frequently and temporarily such as weather, news, or sports. The JUMP button lets you quickly tune to a specific channel and then tune back to the original channel by pressing the button again (see *Figure 45*).

If the JUMP button is set to *JumpSet*, pressing the JUMP button will immediately tune to the programmed channel. Pressing the JUMP button again will return to the channel to which you had been listening immediately prior to pressing the JUMP button.

**Note: The JUMP button setting remains the same regardless of which preset bank is currently selected.**

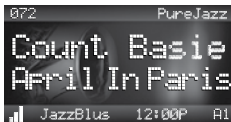

Figure 45

## Memory (MEMO) and Song Seek (S-Seek) Functions

Your Sportster 6 lets you to capture and store information (artist, song, sports team, or traffic city) about the programming on the currently-tuned channel, up to a total of 50 items. The Sportster 6 then continuously searches all the SIRIUS channels and alerts you when a match to a saved program is being played. When a sports team (or teams) are stored in memory, at the time the radio is initially powered on, you will be alerted when the sports teams are playing in a game being broadcast. Also, while listening to your SIRIUS radio, you will be alerted should one of the teams begin to play a game.



### Storing Artist Names, Song Titles, and Sports Teams to Memory

If you are listening to a song or other entertainment channel, or a sports team, and wish to save the artist, song, or sports team selection to memory for future S-Seek alerts, do the following:

**For Artist Names or Song Titles:** If the currently tuned-channel is a music or entertainment channel, momentarily press and release the MEMO button. The radio will display a menu to choose to store the artist name or the song title (see *Figure 46*).



Figure 46

If either the artist name or song title is not available to save, the choice will be displayed as unavailable (see *Figure 47*).



Figure 47

Turn the Knob (on the remote, use the Channel UP/DOWN buttons) to highlight STORE ARTIST or STORE SONG (when available) and press the Select button to save the current selection to memory.

If both the artist and song are available to save, you will be prompted again to save whichever one you haven't yet saved, song title or artist name. If you do not wish to save, press the MEMO button to exit.

**For Sports Events:** If the currently-tuned channel is an NFL, NBA, NHL, NASCAR or college play-by-play sports broadcast, momentarily press and release the MEMO button. The Sportster 6 will display a menu to choose which sports team (or for NASCAR, which car number) should be saved to memory (see *Figure 48*)

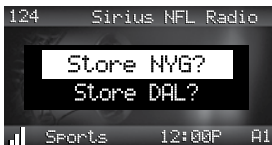

Figure 48

If either of the teams is not available to save, that team will be displayed as unavailable (see *Figure 49*).

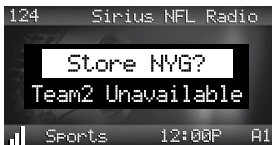

Figure 49

Turn the Knob (on the remote, use the Channel UP/DOWN buttons) to highlight the desired sports team or car number (when available) and press the Select button to save the current selection to memory.

The next screen will ask which kind of alert you wish to have (see *Figure 50*).



**Figure 50**

**ALERT: INITIAL** will provide a pop-up alert when the team you have chosen is playing a game; **All** will provide a pop-up alert when the team you have chosen is playing a game, and when the score for the game is updated.

**TICKER:** Displays the information (including the channel that is carrying the game) for the team continually during a game they are playing. The currently-playing artist and song title will still be visible when the ticker is active.

Turn the Knob (on the remote, use the Channel UP/DOWN buttons) to highlight the desired alert and press the Select button to choose the desired alert setting. To save your selection turn the Knob to highlight DONE and press the Select button. If you do not want to save, press the MEMO button to exit.

The radio will then revert to the last active display mode.

If the new alert was successfully stored in memory, an **ARTIST/SONG/GAME STORED** pop-up screen followed by an **X USED/Y EMPTY** screen will be displayed for one and two seconds respectively. **X** is the total number of listings stored in memory, and **Y** is the total number of memory listings still available for storage (see *Figure 52*).



**Figure 51**

If all of the memory spaces are full when you press the MEMO button, a MEMORY FULL screen will be displayed for one second (see *Figure 52*).



Figure 52

A REPLACE-CANCEL screen will then be displayed (see *Figure 53*).



Figure 53

Turn the Knob (on the remote, use the Channel UP/DOWN buttons) to highlight whether to replace an existing alert or cancel saving the alert to memory, and press the Select button. If you chose to cancel saving the alert, the Sportster 6 will revert to the last active display mode. If you chose to replace an existing alert, a listing of all the alerts stored in memory will be displayed (see *Figure 54*).



Figure 54

Each listing will be preceded by an icon that identifies the type of listing: a musical note for songs, a happy face for artists and a flag for sports teams/cars.

Turn the Knob (on the remote, use the Channel UP/DOWN buttons) to highlight the alert that you would like to replace and press the Select button to store the new alert. If the new alert was successfully stored in memory, the ARTIST/SONG/GAME STORED pop-up screen followed by the X USED/Y EMPTY screen will be displayed for one and two seconds respectively (see *Figure 51*, on page 66). The Sportster 6 will then revert to the last active display mode.

### Viewing Program Information stored in Memory

To view the program information stored in memory:

1. Press and hold the MEMO button for three seconds to enter the S-Seek Browse mode. The program information stored in memory will be displayed in one-at-a-time page format.
2. Use the Knob (on the remote, use the Channel UP/DOWN buttons) to scroll through the listings. This function allows you to review previously stored program information. The information will be displayed as sports league or college/team name or artist name/song title (see *Figure 556*).

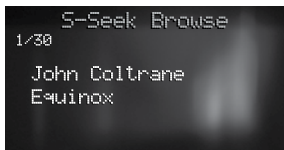

Figure 55

### Deleting a Song Title Stored in Memory

To delete a song title stored in memory:

1. Press and release the Select button while in S-SEEK mode. A pop-up screen displaying various selectable options will be displayed (see *Figure 56*).

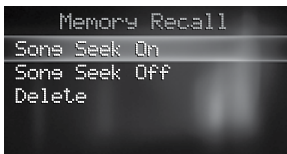

Figure 56

2. Turn the Knob (on the remote, use the Channel UP/DOWN buttons) to highlight the DELETE option.
3. Press the Select button. A DELETE confirmation screen will appear (see *Figure 57*).

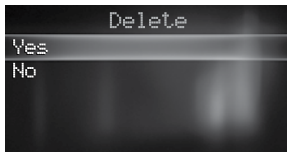

Figure 57

4. To permanently delete the program from your list, use the Knob (on the remote, use the Channel UP/DOWN buttons) to highlight YES and press the Select button to confirm. The S-Seek Browse mode screen (Figure 55, on page 68) will return.

### Activating the Song (S-Seek) Alert

When S-Seek alerts are enabled, whenever the Sportster 6 is on it automatically searches the channels to determine if a match exists with the program information stored in radio's memory. If one or more matches are found, a S-SEEK ALERT pop-up screen appears (see *Figure 58*, left) and an audible beep tone is heard, indicating that a match was found. If more than one match is found the My SIRIUS SEEKS screen appears (see *Figure 58*, right), and you can use the Knob (on the remote, use the Channel UP/DOWN buttons) to select the song that you wish to listen to. If you do not make a selection within 10 seconds, the screen will revert to the last active display screen and tuning mode.



Figure 58

To turn on S-Seek alerts:

1. Press and hold the MEMO button for three seconds to enter the S-Seek mode.
2. Press the Select button. A pop-up screen displaying three selectable options, SONG SEEK ON, SONG SEEK OFF and DELETE are displayed (see *Figure 56*, on page 69).
3. Use the Knob (on the remote, use the Channel UP/DOWN buttons) to highlight the SEEK ON option.
4. Press the Select button to turn on S-Seek alerts.

## SPORTS ALERT

Your Sportster 6 can automatically identify when your favourite sports team is playing. When a game is found, a **SPORTS ALERT** is displayed listing the sports events which are currently being played (see *Figure 59*, left). Press the Select button to tune to the event. If more than one match is found the **MY SPORTS ZONE** screen appears (see *Figure 59*, right), and you can use the Knob (on the remote, use the Channel UP/DOWN buttons) to select the game that you wish to hear.



Figure 59

Refer to the *Sports Alerts* section on page 91 for information on setting your favourite sports teams. You can also use the S-Seek feature to add sports alerts for additional teams. Refer to the *For Sports Events* paragraph on page 65 for more information.



## Instant Replay

The Sportster 6 is capable of storing the audio of the channel that you're listening to for later playback (up to approximately 60 minutes, depending upon the channel to which you are tuned). As soon as you tune to a channel, the radio automatically begins storing the audio, enabling you to rewind at any time to replay the audio again.

- **PLAY/PAUSE Button >II** : If you are unable to continue listening to a channel, but don't want to miss the broadcast, pressing the PLAY/PAUSE button will mute the audio and mark the point in the broadcast so you can use Instant Replay to resume listening at a later time. **Pressing and releasing** the PLAY/PAUSE button again while the Sportster 6 is muted begins playing the stored audio from the point at which the program was paused. During Instant Replay playback, the Sportster 6 continues to store the channel's live audio.

**Pressing and holding** the PLAY/PAUSE button changes the display to a listing of the artist's names in the stored audio, from the most recent to the oldest, beginning with an entry called LIVE. Pressing the button toggles the display between the artist name list and the song/program title list (see *Figure 60*). Use the Knob to highlight a song to play and press the Select button to select it. Choosing LIVE exits the Instant Replay mode, and the Sportster 6 resumes playing the live broadcast.

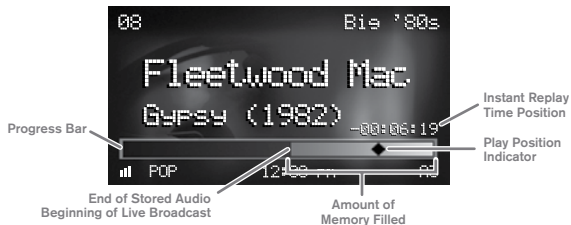

Figure 60

- **FAST-FORWARD Button** ⏩ : This fast-forwards through the stored audio. **Pressing-and-releasing** the FAST-FORWARD button forwards to the start of the next song or program in the stored audio and playback automatically begins from there. Repeatedly pressing and releasing the **Fast-Forward** button continues to move forward in the stored audio to the starts of each song or program until the end of the stored audio is reached. When the end of the stored audio is reached, you will hear a beep and the Sportster 6 will exit the Instant Replay mode and resume playing the live broadcast. **Pressing-and-holding** the FAST-FORWARD button for one second advances the Instant Replay playback forward in 10-second intervals, which increases to 15- and then 30-second intervals the longer you press the button. Playback begins immediately when you release the button. When you reach the end of the stored audio you will hear a beep, the Sportster 6 will exit the Instant Replay mode and resume playing the live broadcast.
- **REWIND Button** ⏪ : This rewinds (moves backwards) through the stored audio. **Pressing-and-releasing** the REWIND button rewinds to the start of the current song or program in the stored audio, and playback automatically begins. Repeatedly pressing and releasing the REWIND button continues to move backwards in the stored audio to the start of each previous song or program until the beginning of the stored audio is reached. If you reach the beginning of the stored audio you will hear a beep and Instant Replay playback automatically begins. Depending upon where in a particular broadcast the channel was selected, the start of a song or program may not be available in memory. If this occurs, playback will start from where the audio began to be stored. **Pressing-and-holding** the REWIND button for one second rewinds the Instant Replay playback in 10-second intervals, which increase to 15- and then 30-second intervals the longer you press the button. Playback begins immediately when you release the button. If you reach the beginning of the stored audio while rewinding you will hear a beep and playback will automatically begin.

**Note:** When the radio is tuned to another channel, all audio stored in the Instant Replay memory is erased and the tuned channel begins to play. Tuning to another channel may automatically occur if another feature of the radio has been programmed to do so.

- **Progress Bar.** While playing from Instant Replay memory, status information is shown at the bottom of the Sportster 6's display screen (see *Figure 61*).



**Figure 61**

As the Instant Replay memory fills, the Progress Bar fills from the right side, providing a visual indication of how much of the Instant Replay memory is filled. The end of the bar indicates the end of the stored audio, where the live broadcast begins. When all available memory has been used, the bar will be completely filled all the way to the left.

A diamond-shaped Play Position Indicator is superimposed over the Progress Bar, indicating the current playback position in the Instant Replay memory. When you are playing the stored audio, this indicator will move to the left, showing the progression of the playback through the Instant Replay memory. When you pause the playback, the Play Position Indicator will stop moving, indicating your current position in the Instant Replay memory.

While you are in the playback mode, the radio continues to store the audio from the channel. Obviously, you will be unable to “catch up” to the live broadcast during playback, as new audio is being stored at the same rate at which you are playing back the stored audio. You can use the **FAST-FORWARD** button to skip ahead or exit the Instant Replay mode, and begin listening to the live broadcast again.

When paused, and the Instant Replay memory is 10 seconds from becoming full, you will hear two beeps (if the Power-Up Tone option is enabled). When the memory is full, the Sportster 6 will automatically begin playback, and will continue to store the channel audio, overwriting the oldest portion of the audio previously stored.

The Instant Replay Time Position indicates the exact amount of time the Play Position Indicator (see *Figure 61*, on page 74) is behind the live broadcast, expressed as Hours:Minutes:Seconds, and displayed as a negative number. For example, if  $-00:02:40$  is displayed, this would indicate that the Play Position Indicator is 2 minutes and 40 seconds behind the live broadcast.

When you put Instant Replay into the Fast-Forward, Rewind or Pause Modes, icons appear on the screen to indicate the active mode (see *Figure 62*).



**Figure 62**

## FM Presets Button

If you are using a wireless connection between your Sportster 6 and your vehicle's audio system (see page 42), you can easily select between the five different FM transmitter preset frequencies by pressing the FM Presets/MENU button (or pressing the FM Presets button on the remote).

1. Press the FM Presets/MENU button (on the remote, press the FM Transmitter button). The currently-stored FM preset will appear (see *Figure 63*). The Sportster 6's FM transmitter 'broadcasts' on the FM frequency shown.



Figure 63

2. To switch the Sportster 6's FM transmitter to the next stored FM preset, press the FM Presets/MENU button again (on the remote, press the FM Presets button again). The Sportster 6's FM transmitter now broadcasts on this FM Preset 2's frequency (see *Figure 64*). Each press of the FM Presets/MENU button (or each press of the FM Presets button on the remote) will change to the next FM Preset. (Pressing the FM Presets/MENU button while FM Preset 5 is active will change back to FM Preset 1.)

Note: To set or change the FM Preset frequencies, see *FM Transmitter*, on page 80.



Figure 64

# Menu Options

Menu Options allows you to set and/or change the various features and settings of your Sportster 6. To enter the menu options, press and release the MENU button. The MENU OPTIONS screen will be displayed (see *Figure 65*).

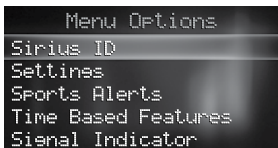

Figure 65

Use the Knob (on the remote, use the Channel UP/DOWN buttons) to highlight selections in the menu lists and press in the Select button to select them. To exit a menu, press the MENU button.

The following selections (shown in bold text) are available from the MENU OPTIONS screen, and allow you to change the parameters for the items listed under the heading:

## **Sirius ID**

### **Settings**

- FM Transmitter
- Jump Settings
- Display Settings
- S-Seek Alert Settings
- Audio Levels
- Channel Preview
- Factory Default
- Parental Control

## **Sports Alerts**

### **Time Based Features**

- Clock
- Alarm
- Program Alert
- Sleep Mode
- Auto Shutdown

## **Signal Indicator**

Each of these menu options is explained in the following sections. Note that if a selection is not made within 10 seconds, the Sportster 6 will exit the MENU OPTIONS screen and revert back to the Default display screen.

## Sirius ID

This displays your 12-digit SIRIUS ID (SID) number (see *Figure 66*). The SID is unique to each SIRIUS radio, and is required to activate your SIRIUS service. We recommend that you write this number in the space provided near the end of this user guide. No adjustments are allowed in this mode. To exit, press the Select button or press the MENU button.

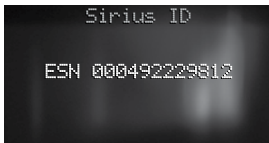

Figure 66

## Settings

The Settings menu allows you access the following settings:

- FM Transmitter
- Jump Settings
- Display Settings
- S-Seek Alert Settings
- Audio Levels
- Channel Preview
- Factory Default
- Parental Control

Press the MENU button, then highlight and select SETTINGS. The SETTINGS screen will appear (see *Figure 67*).



Figure 67



## FM TRANSMITTER

The FM TRANSMITTER menu option allows you to enable or disable the Sportster 6's built-in FM transmitter, and select up to 5 different FM transmitter frequencies.

### FM Presets

1. Select the FM TRANSMITTER menu option. The FM TRANSMITTER screen will appear. See *Figure 68, left*.



Figure 68

2. Highlight FM and press the Select button to select ON or OFF. (Selecting OFF turns the Sportster 6's FM transmitter OFF.)
3. Highlight and select SET FM PRESETS. The SET FM PRESETS screen will appear (see *Figure 68, center*).
4. FM1 is factory-set to 88.1MHz. This may not be the best frequency for your area. To change it, highlight and select FM1. The SET FM PRESET 1 screen will appear (see *Figure 68, right*).
5. Highlight an FM frequency that's not being used by a broadcaster in your area, then press the Select button to select it. The SET FM PRESETS screen will return.
6. Repeat Steps 4 and 5 to set FM transmitter frequency presets FM2 – FM5.

**Note:** To switch the FM transmitter preset frequency while listening to your Sportster 6, press the FM Presets/MENU button on the Sportster 6 front panel, or press the FM Presets button on the remote.

## DISPLAY SETTINGS

You can control the Sportster 6's Auto Dimmer feature, adjust the brightness and contrast of the Sportster 6's color LCD display screen, and can select from 15 different color options for the screen and the Sportster 6's buttons:

Select the DISPLAY SETTINGS menu option. The Display Settings screen will appear (see *Figure 69*). Select one of the following options:



Figure 69

**BRIGHTNESS:** You can manually set the brightness for the LCD backlight and the front-panel buttons, and you can control the action of the Sportster 6's auto dimmer feature. When you select the Brightness option, the Brightness screen will appear (see *Figure 70*, left).



Figure 70

**MANUAL:** The Manual Brightness screen will appear (see *Figure 70*, right). Use the Knob to manually adjust the display's brightness. The bar graph on the display screen will move to indicate the change. When you're finished, press the MENU button to exit.

- Setting the brightness to the lowest setting enables a *Dark Mode* that extinguishes all

illumination except for 5 seconds after any button is pressed. This is useful when using the Sleep Mode (see page 99).

**Note:** You can increase and reduce the screen brightness without entering the Menu system by pressing and holding the Category < and > buttons (see pages 47 – 49).

**AUTOMATIC:** This lets you control the Sportster 6's auto dimmer feature. The auto dimmer will automatically dim the Sportster 6's display in low-light conditions, and will automatically brighten the display when the ambient light is bright.

1. When the AUTO BRIGHTNESS screen appears (see *Figure 71*), use the Knob to highlight either the "L" or "H" indicator.

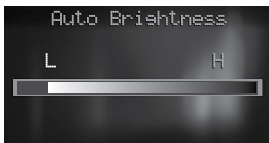
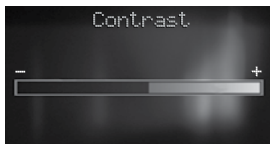

**Figure 71**

- The "L" indicator controls how much the Sportster 6's display will automatically dim in low-light conditions. The "H" indicator controls how much the Sportster 6's display will automatically brighten in high ambient light conditions.
2. Use the Category <> buttons to adjust the value of the highlighted indicator.
  3. Use the Knob to highlight the other indicator and use the Category <> buttons to set its value.
  4. Press the Select button to save the settings and return to the BRIGHTNESS screen.
    - Pressing the MENU button will cancel your settings and return to the BRIGHTNESS screen.

**Contrast:** This setting adjusts the relationship between the background and the text on

the LCD display screen. The bar graph on the display screen will move to indicate the change (see *Figure 72*). When you're finished, press the MENU button to exit



**Figure 72**

**Color Options:** You can select from 15 different color combinations for the Sportster 6's LCD screen background and text, and the front-panel button backlight color. Selecting **COLOR OPTIONS** activates the **COLOR OPTIONS** screen. Turning the Knob (on the remote, pressing the Channel UP/DOWN buttons) will cycle the Sportster 6 through the following color combinations:

<b>SCREEN BACKGROUND</b>	<b>SCREEN TEXT</b>	<b>BUTTON BACKLIGHT</b>
Blue	White	Blue
Blue	Amber	Blue
Green	White	Green
Pink	White	Pink
Red	White	Red
Amber	White	Amber
Aqua	White	Aqua
White	Blue	Blue
Dark Gray	Blue	Blue
Dark Gray	Red	Red
Dark Gray	White	White
Dark Gray	Green	Green
Dark Gray	Amber	Amber
Dark Gray	Pink	Pink
Dark Gray	Aqua	Aqua

**Note:** The screen background, screen text and button backlight colors will change in real-time as you turn the Knob or press the Channel UP/DOWN buttons.

## S-SEEK ALERT SETTINGS

This menu lets you turn S-Seek ON or OFF, turn the audible alert tone ON or OFF, turn the on-screen alerts ON or OFF and browse all of the S-Seek memory entries. In addition, you can clear all 50 S-Seek entries.

1. Select the S-SEEK ALERT SETTINGS menu option (see *Figure 73*).

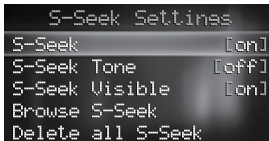

Figure 73

2. The following S-Seek options are available:

**S-SEEK:** Turns the S-Seek function ON or OFF.

**S-SEEK TONE:** Turns the audible S-Seek alert ON or OFF.

**S-SEEK VISIBLE:** Turns the on-screen S-Seek alerts ON or OFF (see *Figures 58 & 59* on pages 70 & 71).

**BROWSE S-SEEK:** Lets you look-through all of your S-Seek memory entries.

**DELETE ALL S-SEEK:** This clears all S-Seek memory entries. When selected, a CLEAR ALL MEMORY confirmation screen will be displayed. Select YES to clear all S-Seek entries or No to cancel.

## AUDIO LEVEL

You can adjust the audio output level of your Sportster 6 to match the levels of the other source components in your audio system, or to fine-tune the audio level for best performance. This is important when using both the included Vehicle Dock or the optional Home Docking Station. The audio level setting affects both the Audio Output and the FM transmitter output audio levels.

1. Select the **AUDIO LEVEL** menu option. The **AUDIO LEVEL** screen will appear (see *Figure 74*).



Figure 74

2. The **POWER-UP TONE** sounds when the Sportster 6 powers ON or OFF. Use the **Select** button to cycle between ON and OFF.
3. Highlighting and selecting **AUDIO LEVEL** displays the **AUDIO LEVEL** screen, which has a "-" sign to the left and a "+" sign to the right (see *Figure 75*). Use the **Knob** (on the remote, use the **Channel UP/DOWN** buttons) to adjust to the desired audio output level.

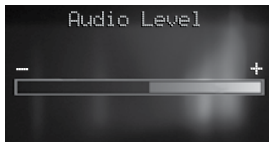

Figure 75

## CHANNEL PREVIEW

Activating Channel Preview lets you browse what's on other channels when the Default Screen is active. Normally, when the Default Screen is active, rotating the Knob or pressing a Channel UP or DOWN button on the remote automatically tunes the Sportster 6 to the next higher or lower channel. When Channel Preview is active, rotating the Knob or using the Channel UP/DOWN buttons will change the display to show what's on the next higher or lower channel while the Sportster 6 remains tuned to the channel you're listening to.

- If you want to listen to the new channel, press the Select button. If you don't press the Select button, after 5 seconds the Sportster 6's display reverts back to the Default Display.

### To activate Channel Preview:

1. In the SETTINGS screen (see page 79), highlight the CHANNEL PREVIEW option (see *Figure 76*).

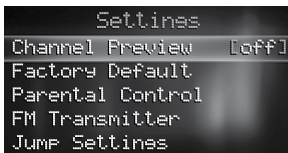

Figure 76

2. Use the Select button to cycle between ON and OFF. (Default is OFF.)



## FACTORY DEFAULT

The FACTORY DEFAULT option will restore all the original factory settings in your Sportster 6. Note that factory default will *not* reset the lock code if you have changed it from the default lock code (see page 90). To perform a factory default reset:

1. Select the Factory Default menu option. The FACTORY DEFAULT screen will appear (see *Figure 77*, left).



Figure 77

2. Use the Select button to choose Yes or No. Choosing No will cancel the operation and return to the MENU OPTIONS screen. If you choose Yes you will be asked to confirm your choice (see *Figure 77*, right). Choosing Yes again reverts the following Sportster 6 parameters to their original factory settings:

- All presets revert to empty
- Reset to Normal Tuning Mode
- Reset to Default screen
- Reset previous power state setting to: Off
- FM Frequency Setting: 88.1MHz
- FM Transmitter: On
- Sports Alert: Clear all favourite teams
- Jump Settings: Clear jump setting
- Display Brightness: 80%
- Display Contrast: 50%
- Auto Memory Search: On
- Clear all S-Seek stored entries
- Audio Level: -3dB
- Power-Up and S-Seek Tones: On
- Clock Format: 12 Hour
- Clock Time Zone: Eastern Time Zone
- Clock Daylight Savings Time: Observed
- Alarm: Off
- Alarm Time: Cleared (12:00 PM)
- Program Alert: Off
- Program Alert Time: Cleared (12:00 PM)
- Program Alert Day: Cleared (Monday)
- Program Alert Channel: Cleared (184)
- Auto Shutdown: Disabled
- Sleep Mode: Off

## PARENTAL CONTROL

Your Sportster 6 has the ability to lock channels you do not want others (such as children) to access without your permission. Locked channels will not appear when browsing channels with the Knob or Channel Select buttons. When the anyone tries to access a locked channel using the Direct Tuning function (see page 60), an ENTER CODE screen will be displayed and the channel won't be accessed until the correct code is entered.

### Locking or Unlocking a Channel

To lock or unlock a channel:

1. Select the PARENTAL CONTROL menu option. The PARENTAL CONTROL screen will appear (see Figure 78, left).
2. Select the LOCK/UNLOCK menu option. You will need to enter the lock code to pro-

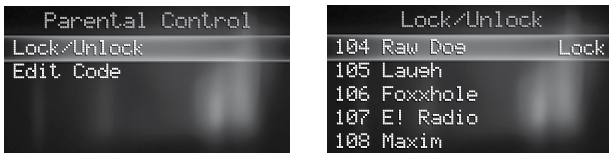

Figure 78

ceed. Refer to *Changing the Lock/Unlock Code*, on page 90 for information on how to set the lock code.

3. Once you enter the lock code the LOCK/UNLOCK screen will appear (see Figure 78, right). Highlight the channel you wish to lock or unlock from the channel list. Pressing the Select button will either add the word *Lock* next to the channel name to indicate that the channel will be locked, or unlock a locked channel by removing the word *Lock*.

### Changing the Lock/Unlock Code

The first time you access the LOCK/UNLOCK menu, you must enter the default lock code. The default lock code is 0 0 0 0. You can keep this code or change it. To change the lock code:

1. Select the PARENTAL CONTROL menu option. The PARENTAL CONTROL screen will appear (see *Figure 78*, on page 89)
2. Select the EDIT CODE menu option. The ENTER CODE screen will appear (see *Figure 79*).



Figure 79

3. Enter the default lock code (0 0 0 0) or the current lock code if you have changed it from the default code.
4. The NEW CODE prompt will be displayed. Enter your new four digit code using the 0 – 9 number buttons. You will then be prompted to enter the new code again to confirm.
5. When the new lock code is confirmed, the lock code is changed.

**Note:** You can use this same procedure to change the lock code again after you have changed it from the default code.

## Sports Alerts

The Sports Alerts screen lets you store your favourite sports teams and NASCAR car numbers in memory. (You may select multiple teams/cars within each sport or league.) Your Sportster 6 will constantly scan the channels and will alert you when a team or car you stored in memory is playing a game or running a race, or when there is a score update for a team, depending upon which options you have chosen for each team or car number. Sports teams which you have selected and which are currently playing will be displayed in a category called *My Sports Zone*.

Select SPORTS ALERTS from the Menu Options. The SPORTS ALERTS screen will appear (see *Figure 80*).

The following options are available:

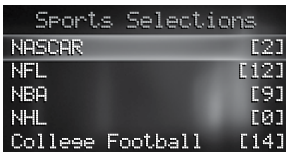

Figure 80

- **SELECTIONS:** Lets you store teams/car numbers in memory and select the types of alerts (Pop-Up Alert and/or Sports Ticker) you want to appear when they are playing. (See Sports Selections on page 92 for details.) The bracketed number indicates the total number of teams and car numbers you have selected.
- **ALERT:** Use the Select button to turn the pop-up alert ON or OFF for all selected teams or car numbers. See page 71 for Alert details.
- **TICKER:** Use the Select button to turn the Sports Ticker ON or OFF for all selected teams or car numbers. See page 95 for details about the Sports Ticker.

## SPORTS SELECTIONS

Choose SELECTIONS from the SPORTS ALERTS screen (see *Figure 80*, on page 91). The SPORTS SELECTIONS screen will appear (see *Figure 81*). Highlight and select the category of the team/car number you wish to add (NASCAR, NFL, NBA, College Football, College Basketball\*). The bracketed numbers indicate the number of teams/car numbers you have already selected for each category.



Sports Selections	
NASCAR	[2]
NFL	[12]
NBA	[9]
NHL	[0]
Collese Football	[14]

Figure 81

## NASCAR

The NASCAR screen will appear when you select NASCAR (see *Figure 82*, left).



Figure 82

1. Highlight SELECT CARS, then press the Select button. The SELECT CARS screen will appear (see *Figure 82*, center).
2. To select a driver's car number, highlight and select ADD NEW CAR?. Enter the driver's car number on the ADD NEW CAR screen that appears (see *Figure 82*,

\* Please note NHL programming is no longer available in Canada. Visit [sirius.ca](http://sirius.ca) for up-to-date programming.

right). After you enter the number, press the Select button. Repeat this for each driver you want to follow. (You can select a maximum of 5 cars.)

Selecting the **ALL CARS** option notifies you when any NASCAR driver is racing. You can choose to be notified either by the pop-up NASCAR Alert, by the NASCAR ticker, or by both (see *Figure 83*, below):

- a) Pressing the Select button will select **TICKER** (a check-mark will appear in the adjacent box). Pressing the Select button again will select **ALERT**.
- b) Pressing the Select button a third time will deselect **TICKER** (the check-mark will disappear); pressing the Select button a fourth time will deselect **ALERT**.



Figure 83

When you're done selecting drivers/car numbers, press the Menu button. The NASCAR screen will return (see *Figure 82*, left, on page 92). Select the types of NASCAR alerts you want:

**RACE ALERT:** Displays a pop-up alert when any race featuring your selected cars is running (see *Figure 83*, left). The alert will show the driver's name/car number and the channel carrying the race. Use the Select button to choose **ON** or **OFF**.

**TICKER:** Displays information for races featuring your selected car numbers continually while races are running (see *Figure 83*, right). The currently-playing artist and song title will still be visible when the ticker is active. Use the Select button to choose **ON** or **OFF**.

## NFL, NBA, COLLEGE FOOTBALL, COLLEGE BASKETBALL

When you select one of the above leagues on the SPORTS SELECTIONS screen (see *Sports Selections*, on page 92), that league's screen will appear (see *Figure 84*, left). Note that although the NFL is shown here, the screens for all the leagues contain the same options.



Figure 84

### To Select Teams:

1. Highlight and select **SELECT TEAMS**. The **SELECT NFL TEAMS** screen will appear (see *Figure 84*, right).
2. Select the teams you want to follow (you can select as many teams as you wish). Note that for college teams, you will be alerted for all teams playing for that college. There are 30 college teams currently licensed for broadcast by SIRIUS.
3. For each team you select you can choose to be notified either by a pop-up Sports Alert (see *Figure 59*, on page 71), by the league's ticker (see *Figure 85*, on page 95), or by both:
  - a) Use the Knob to highlight the team you want to follow. Selecting the **ALL TEAMS** option notifies you when any teams in the league are playing.
  - b) While the team is highlighted, pressing the Select button will select **TICKER** (a check-mark will appear in the adjacent box). Pressing the Select button again will select **ALERT**.
  - c) Pressing the Select button a third time will deselect **TICKER** (the check-mark will disappear); pressing the Select button a fourth time will deselect **ALERT**.
4. Repeat Step 3 for each team you want to follow.

### League Settings:

The NFL screen (*Figure 84* left, on page 94) lets you turn Alerts and/or the Ticker ON and OFF for all of your selected teams in the league without having to do so for each team individually:

**GAME ALERT:** A pop-up alert will be displayed when any of your selected teams is playing, and when the team(s) begin playing a game. Use the Select button to choose ON or OFF.

**ALL SCORES ALERT:** Provides the same alerts as the GAME ALERT, and also alerts you when the scores for the team(s) are updated. Use the Select button to choose ON or OFF.

**TICKER:** Displays the information (including the channel that is carrying the game) for the teams you have selected continually during a game they are playing (see *Figure 85*). The currently-playing artist and song title will still be visible when the ticker is active. Use the Select button to choose ON or OFF.

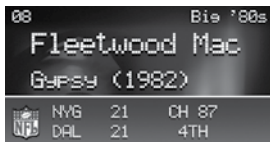

Figure 85



## Time-Based Features

*Time-Based Features* menu lets you access the **CLOCK**, **ALARM**, **PROGRAM ALERT**, **AUTO SHUTDOWN**, and **SLEEP MODE** functions.

Press the **MENU** button and select **TIME BASED FEATURES**. The **TIME BASED FEATURES** screen will appear (see *Figure 86*).



Figure 86

### **CLOCK**

The **CLOCK** screen (see *Figure 87*) allows you to setup the clock that appears on the Default Screen, based on the format desired and the time zone in which you reside. The actual time is provided via the SIRIUS satellite signal, and will automatically update your Sportster 6.

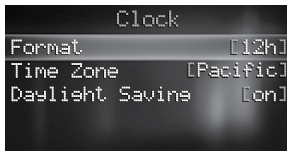

Figure 87

**Format:** Displays the time in either a 12-hour (default) or 24-hour (military) format.

**TIME ZONE:** Since the clock adjusts the time automatically, it is important to specify your time zone. Select from the list of the available time zones:

- (GMT-9:00) Alaska Time Zone
- (GMT-8:00) Pacific Time Zone
- (GMT-7:00) Mountain Time Zone
- (GMT-6:00) Central Time Zone
- (GMT-5:00) Eastern Time Zone
- (GMT-4:00) Atlantic Time Zone
- (GMT-3:30) Newfoundland Time Zone

**DAYLIGHT SAVINGS TIME:** Select **ON** if your area observes Daylight Savings Time; select **OFF** if your area does not.

## ALARM

The **ALARM** screen (see *Figure 88*) lets you to set your Sportster 6 to turn **ON** at a specific time. The last selected channel prior to shutdown will play when the Sportster 6 powers-on. After highlighting an item, use the **Select** button to make your choices.



**Figure 88**

**ALARM TIME:** This lets you set the alarm time. Use the Category < and > buttons and the Knob to select the time when you want the Sportster 6 to power on. (The default time is 12:00 PM). When the desired time is displayed, press the **SELECT** button.

**ALARM TYPE:** This lets you set the alarm to activate at the same time every day, the same time each weekday or only on the days you select.

**ALARM:** Select **ON** to activate the alarm; select **OFF** to de-activate the alarm.

*Snooze function:* When the alarm turns the Sportster 6 ON, pressing any button will mute the audio and turn the backlight off for 8 minutes, after which time the audio and backlight will turn ON again. Pressing the **SELECT** button will cancel the alarm function until the next day but leave the Sportster 6's audio ON; pressing the **POWER** button will turn the Sportster 6 OFF.

## PROGRAM ALERT

The **PROGRAM ALERT** screen (see *Figure 89*) allows you to program the Sportster 6 to switch to a selected channel at a specific time. The Sportster 6 must be powered ON for this feature to function. After highlighting an item, use the **Select** button to make your choices.

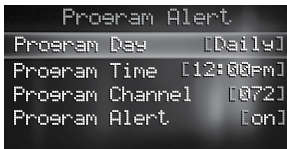

**Figure 89**

**PROGRAM DAY:** You can set the Program Alert to activate every day, weekdays only, weekends only, or on a specific day.

**PROGRAM TIME:** Use the Category < and > buttons and the Knob to set the time the Sportster 6 will switch to the selected channel. AM or PM will change automatically when the AM or PM threshold has been exceeded. When the desired time is displayed, press the **Select** button.

**PROGRAM CHANNEL:** Select the channel you want the Sportster 6 to play.

**PROGRAM ALERT ON/OFF (Default is Off):** Select **ON** to enable Program Alert; select **OFF** to disable Program Alert.

## AUTO SHUTDOWN

The **AUTO SHUTDOWN** screen (see *Figure 90*) lets you program the Sportster 6 to automatically shut OFF after a one-hour period of inactivity (no button presses or other user intervention).



Figure 90

After 59 minutes of inactivity, a beep tone will sound and a **CANCEL AUTO SHUTDOWN** display prompt appears on the screen to allow you to delay the automatic shutdown. Pressing the Select button will reset the *Auto Shutdown* for another 1-hour period.

## SLEEP MODE

The **SLEEP MODE** screen (see *Figure 91*) lets you program the Sportster 6 to shut OFF after a selected period of time.

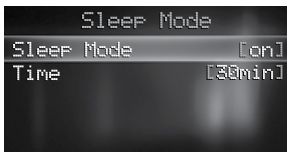

Figure 91

**SLEEP MODE ON/OFF:** Activates and de-activates the Sleep Mode function.

**TIME:** Select the desired amount of time (15/30/45/60 minutes) before the Sportster 6 shuts OFF.

## Signal Indicator

When using the optional Home Docking Station or Boombox indoors, it is important to aim the antenna for maximum signal reception. The SIGNAL INDICATOR screen (see *Figure 92*) visually shows the strength of the satellite and terrestrial signals being received by the Sportster 6. (Refer to the Home Docking Station installation guide for more information about properly orienting the antenna.)

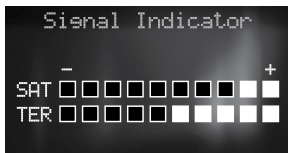

Figure 92

The SAT bar graph indicates the strength of the satellite signal strength; the TER bar graph indicates the strength of the terrestrial signal strength (if available).

# Troubleshooting

<b>Symptom</b>	<b>Solution</b>
Sportster 6 does not power on	Blown fuse, or the power cable is not properly connected. Check for a bad fuse and check power cable connection
Sportster 6 displays: <i>Antenna Not Detected</i>	The satellite antenna is not connected to the radio dock. Check the satellite antenna connection to the dock.
Sportster 6 displays: <i>Acquiring Signal</i>	No satellite signal is being received. Check for obstacles over or around the satellite antenna. Change the vehicle location to eliminate nearby obstacles (bridges, overpasses, tress, buildings, etc.).
Audio static or loss of clarity	The FM frequency contains static. Locate a quiet FM frequency on your vehicle radio and set the FM transmitter frequency of the SIRIUS Sportster to match. If using the AUX audio connector, check the cable connections.
No sound	The audio cables are not connected, or the FM radio is set to the wrong frequency. Check the audio cables at the radio and the radio. Tune the FM radio to the same FM frequency the SIRIUS radio is tuned.

# Specifications

## **System**

Power Requirements:	9-16 V DC, 500 mA (max)
Operating Temperature:	-4°F to +140°F (-20°C to +60°C)
Audio Output:	1.0 V <sub>rms</sub> (max)

## **Sportster 6 Radio**

Dimensions:	4.5 in (width) x 2.5 in (height) x 0.6 in (depth) 114 mm (width) x 63mm (height) x 17 mm (depth)
Weight:	3.7 oz (105 g)

## **Remote Control**

Dimensions:	1.6 in (width) x 4.1 in (height) x 0.7 in (depth) 41 mm (width) x 105 mm (height) x 18 mm (depth)
Weight:	1.3 oz (37 g)
Battery:	CR2025 (3 V)

## **PowerConnect Vehicle Dock**

Dimensions:	4.0 in (width) x 2.0 in (height) x 1.1 in (depth) 102 mm (width) x 52 mm (height) x 28 mm (depth)
Weight:	1.3 oz (37 g)
Audio Connector:	1/8 in (3.5 mm) female
Antenna Connector:	SMB male

## **PowerConnect Power Adapter**

Dimensions:	3.7 in (width) x 1.7 in (height) x 1.3 in (depth) 94 mm (width) x 43 mm (height) x 34 mm (depth)
-------------	---

Weight: 2.4 oz (69 g)  
Input / Output: 9-16 V DC / 5 V DC, 1.5 A  
Cable Length: 4 ft 7 in (1.4 m)

#### **Vehicle Antenna**

Type: SIRIUS Magnetic Mount  
Connector: SMB female, right angle  
Cable Length: 21 ft (6.4 m)

#### **Aux In Cable**

Connectors: 1/8 in (3.5 mm) stereo male to 1/8 in (3.5 mm)  
stereo male  
Cable Length: 4 ft (1.2 m)



# SIRIUS ID

Write down the SIRIUS ID (SID) of your Sportster 6 in the space provided below.

SID: \_\_\_\_\_





**SIRIUS Customer Service: 1-888-539-7474**  
customer care@siriuscanada.ca

**SIRIUS Canada Inc.**  
135 Liberty Street, 4th Floor  
Toronto, Ontario M6K 1A7  
1-888-539-7474  
<http://www.sirius.ca>



<http://sirius.ca>

SIRIUS Canada Inc.  
135 Liberty Street, 4th Floor  
Toronto, Ontario M6K 1A7

1-888-539-7474